

5<sup>th</sup> Barcelona | Catalonia, Spain  
june 13<sup>th</sup> | 16<sup>th</sup> 2006

European  
Congress  
on Regional  
Geoscientific  
Cartography  
and  
Information  
Systems  
Earth  
and  
Water



Programme

## Welcome to Barcelona 2006!

The Local Organizing Committee, the Institut Geològic de Catalunya and the Institut Cartogràfic de Catalunya, are pleased to welcome you to the *5th European Congress on Regional Geoscientific Cartography and Information Systems*, held in Barcelona from June 12 to 16, 2006.

“Earth and Water” is the theme for this Conference. Barcelona is located at the Western Mediterranean seaside, on a coastal plain which extends at the toe of the Collserola hills. The town is bounded by two rivers which form small deltas at their mouths. This particular geographic and geologic setting synthesizes, to some extent, the Conference theme.

The Scientific Committee has developed thirteen outstanding oral and poster sessions, plus one roundtable and one special session.

The exhibition hall will have numerous commercial and non-profit displays. The halls will serve as a meeting point to discuss technical and related subjects.

Barcelona is acknowledged worldwide for its multiple urban monuments and neighborhoods, especially after the successful Summer Olympics in 1992 and the Forum on Cultures in 2004. Barcelona is also well known for its fine restaurants and Mediterranean cuisine.

A variety of museum visits will be available to the attendees.

We wish you a pleasant and fruitful stay in Barcelona.

The Local Organizing Committee

# CONGRESS PALACE LOCATION

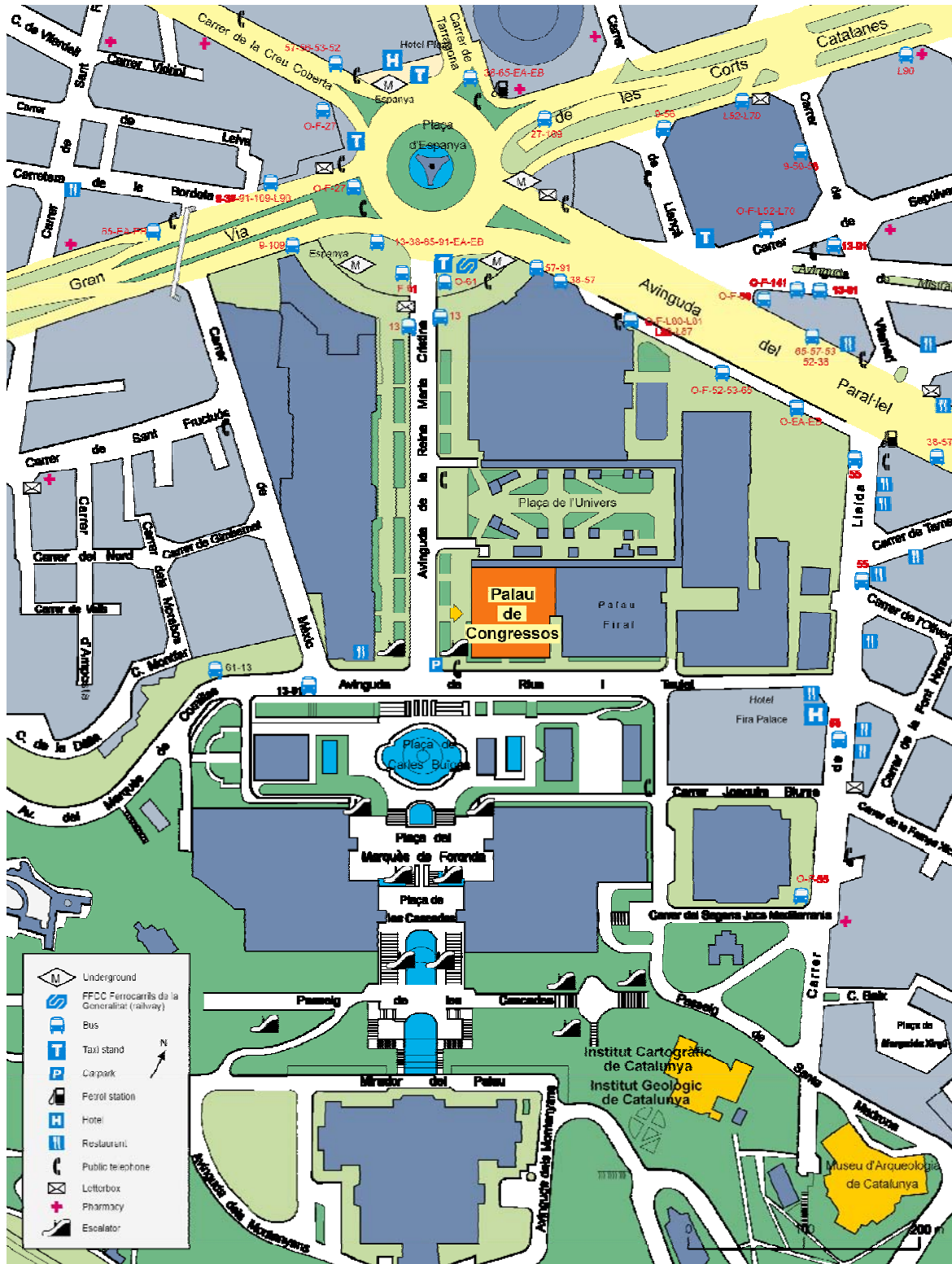

## SAFETY, SECURITY, AND EMERGENCY INFORMATION

The Local Organizing Committee and the Fira de Barcelona has taken many steps to provide a safe and secure environment. However, your safety and security are ultimately an individual responsibility. We recommend your awareness of the safest evacuation route relative to your location at all the times during the conference.

### **First Aid**

A professional first aid supply will be available during the congress from 9:00 to 19:00.

### **Security**

Conference security has been arranged to handle security-related problems. Please, report any and all security issues to one of the following:

- The Local Organizing Committee staff person, identifiable by their orange badge
- The Registration Desk

### **Emergencies**

The emergency number in Barcelona is 061

### **Hotels**

We encourage you to review the safety and security information provided at your hotel during your stay.



## CONGRESS ACTIVITIES AND HIGHLIGHTS

### **Opening Ceremony**

Date: Tuesday, June 13, 15:00-18:45

Location: Room 5 (Level 2)

The official beginning of the 5<sup>th</sup> European Congress on Regional Geoscientific Cartography and Information Systems, ECONGEO 2006, is the Opening Ceremony Tuesday afternoon.

The session will start with the Official Opening by the Promoting Committee. The Catalan Minister for Política Territorial i Obres Públiques, and President of the Institut Geològic de Catalunya, Mr. Joaquim Nadal; the Emilia-Romagna Minister for Sicurezza Territoriale Sicurezza Territoriale, Difesa del Suolo e della Costa, Protezione Civile and the Präsident Bayerisches Landesamt für Umwelt, Mr. Albert Göttle will welcome VIPs, attendees and exhibitors to the conference.

Remarks and greetings by the Scientific Committee will be followed by an invited lecture on the Role of Geological Surveys, Running the 21<sup>st</sup> Century, by José Pedro Calvo, General Director of the Instituto Geológico y Minero de España.

After the welcome and general remarks by the Local Organizing Committee, the Opening Ceremony concludes with keynote lectures by Morten Smelror, Director of Geosciences Division, Geological Survey of Norway; Luca Montanarella, Secretary of the European Soil Bureau Network, European Commission; Kristine Asch, Section Head, Federal Institute for Geosciences and Natural Resources, and Anselm Smolka, Head of Geophysical and Hydrological Risks, Munich Reinsurance Company.

### **Welcome drink and opening of the exhibition**

Date: Tuesday, June 13, 18:45-20:30

Location: Exhibits Area (Level 0)

Admittance: By badge only

The welcome drink starts the opening of the exhibition. Enjoy Spanish wine, beer, cava and tapas as you socialize with the other participants and exhibitors, and get a sneak preview of the exhibits on display. Exhibitors will be on hand to greet you and encourage you to stop by their stands for in-depth discussion later in the week.

### **Social Dinner**

Date: Wednesday, June 14

Those who have pre-paid the Congress dinner fee should meet outdoors the Congress Palace Site for transportation at 20:00. Please contact Registration Desk for details.

Few tickets are still available at the Registration Desk (Level 1).

## VISITS TO MUSEUMS

General information can be obtained at the Registration Desk, Level 1.

The following Museums kindly offer free entrance to all the 5<sup>th</sup> European Congress on Geoscientific Cartography and Information Systems. Congress participants must wear the Congress badge for free entrance.

### 1. Museu de les Aigües (Water Museum) Fundació AGBAR

Address: Can Serra

Carretera de Sant Joan Despí, núm. 1

08940 Cornellà de Llobregat (Barcelona)

Phone: 93 342 35 00

Guided visits (1 Hour; English Language): Wednesday, June 14 and Friday, June 16. Interested participants on guided visits must register at the Congress Registration Desk (Level 1).

Transportation: **Trambaix** Tramway from Plaça Francesc Macià to stop **Aigües** de Cornellà.

### 2. CosmoCaixa: Museu de la Ciència (Science Museum)

Address: Carrer Teodor Roviralta 47-51

08022 Barcelona

Phone: 93 212 60 50

Transportation: **Bus line 60**

### 3. Museu d'Arqueologia de Catalunya (MAC) (Archaeological Museum)

Address: Pg Santa Madrona, 39\*41. Parc de Montjuïc

08038 Barcelona

Phone: 934 246 577

Transportation: The Museu d'Arqueologia is located at the Montjuïc area, at a walking distance from the Congress Palace, close to the Institut Cartogràfic de Catalunya.





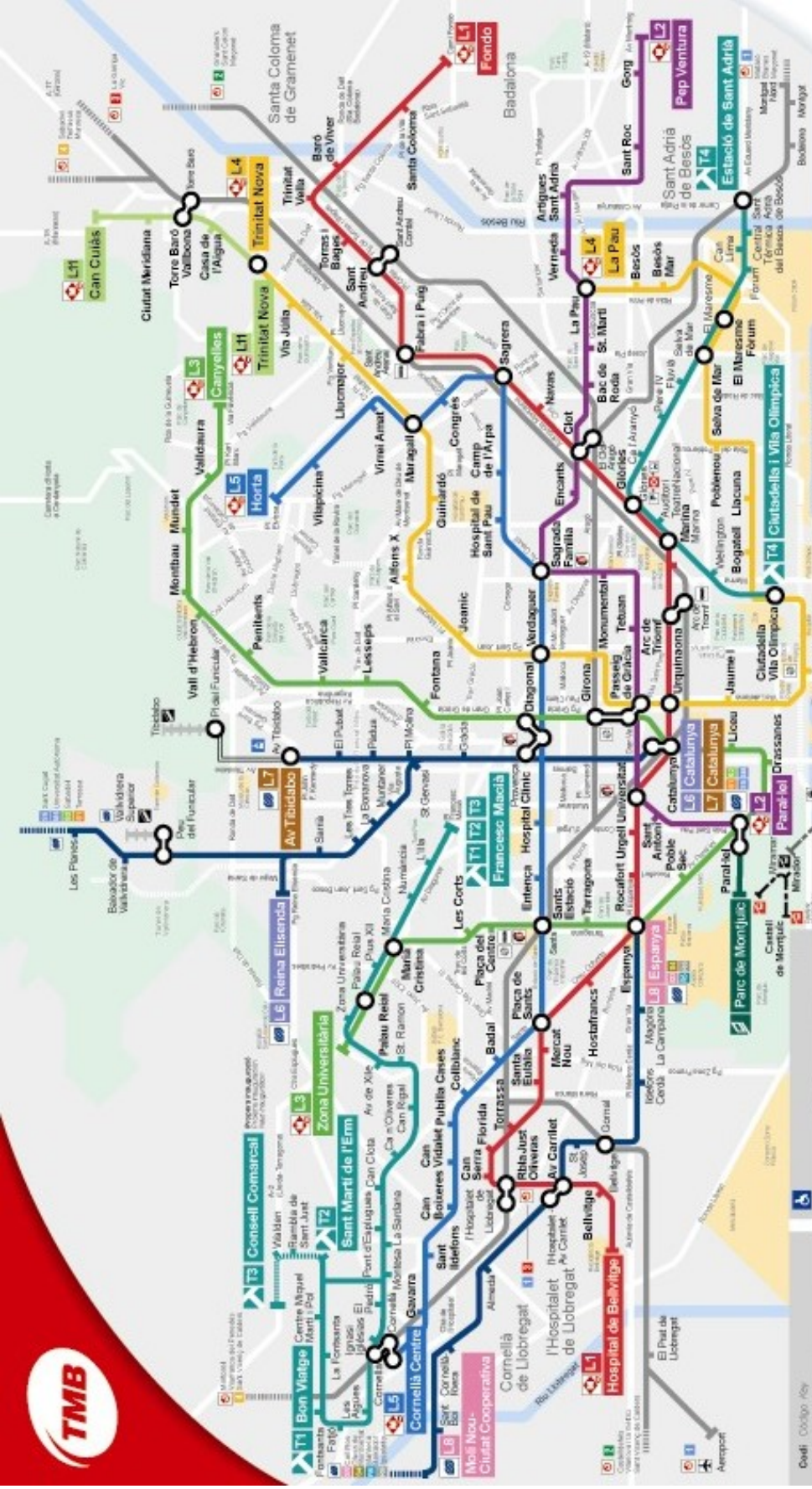

**Abandonar el vehicle a l'entrada**  
**Parcings**

- P** Parcings de vehicles particulars
- P** Parcings de vehicles comercials
- P** Parcings de vehicles de nova matriculació
- P** Parcings de vehicles de nova matriculació
- P** Parcings de vehicles de nova matriculació
- P** Parcings de vehicles de nova matriculació

**Accés**

- A** Accessos accessibles
- A** Accessos accessibles
- A** Accessos accessibles
- A** Accessos accessibles
- A** Accessos accessibles
- A** Accessos accessibles

**Estacions**

- Estació** Estació
- Estació** Estació
- Estació** Estació
- Estació** Estació
- Estació** Estació
- Estació** Estació

**Estacions d'intercanvi**

- Estació** Estació
- Estació** Estació
- Estació** Estació
- Estació** Estació
- Estació** Estació
- Estació** Estació

**Estacions de línia**

- Estació** Estació
- Estació** Estació
- Estació** Estació
- Estació** Estació
- Estació** Estació
- Estació** Estació

**Estacions de línia**

- Estació** Estació
- Estació** Estació
- Estació** Estació
- Estació** Estació
- Estació** Estació
- Estació** Estació

**Estacions de línia**

- Estació** Estació
- Estació** Estació
- Estació** Estació
- Estació** Estació
- Estació** Estació
- Estació** Estació

**Estacions de línia**

- Estació** Estació
- Estació** Estació
- Estació** Estació
- Estació** Estació
- Estació** Estació
- Estació** Estació

**Estacions de línia**

- Estació** Estació
- Estació** Estació
- Estació** Estació
- Estació** Estació
- Estació** Estació
- Estació** Estació



**Metro**

Tots Movem Barcelona

# ROOM ASSIGNMENTS

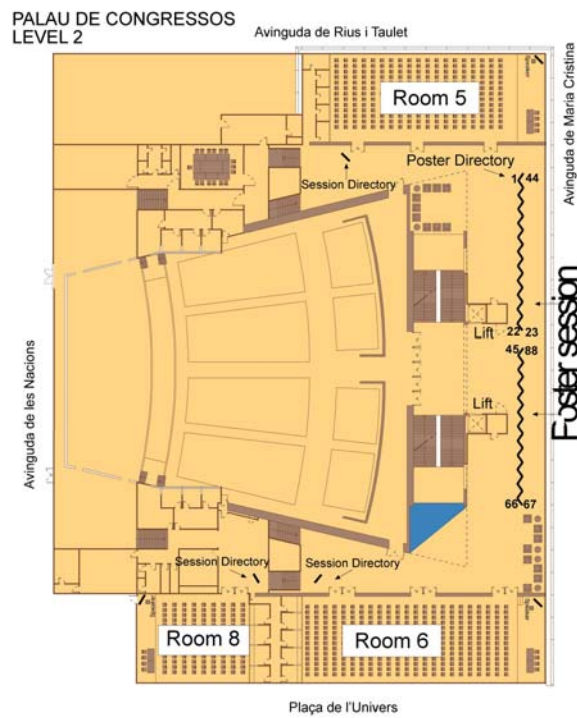
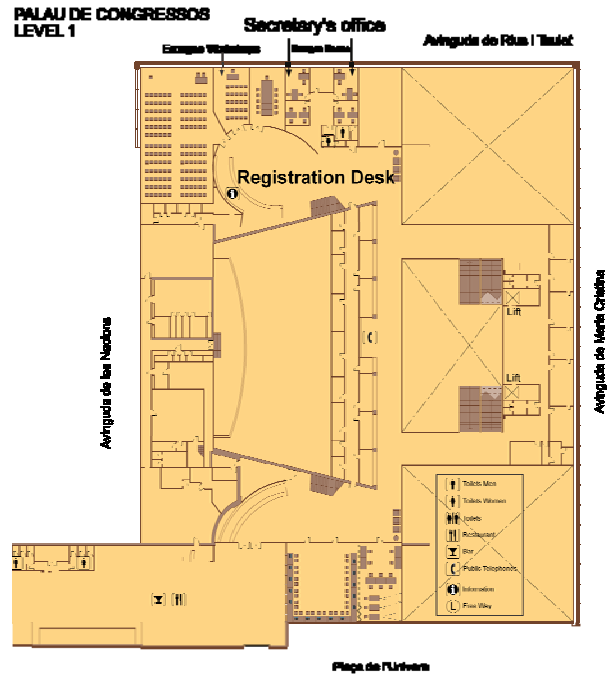
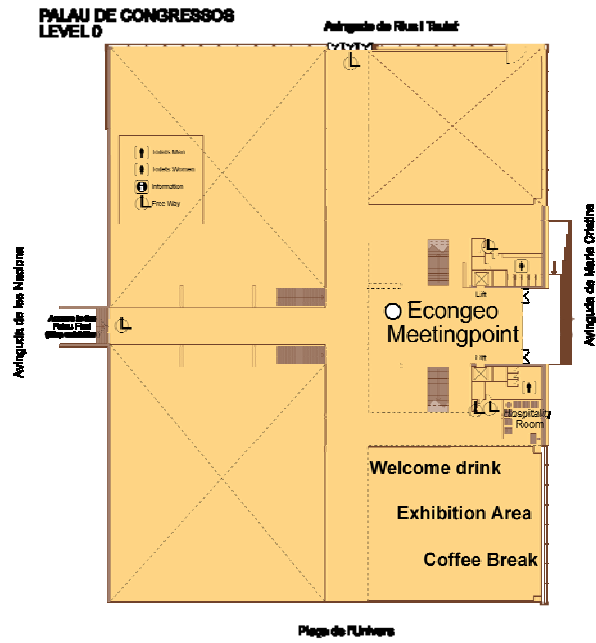

## STANDS

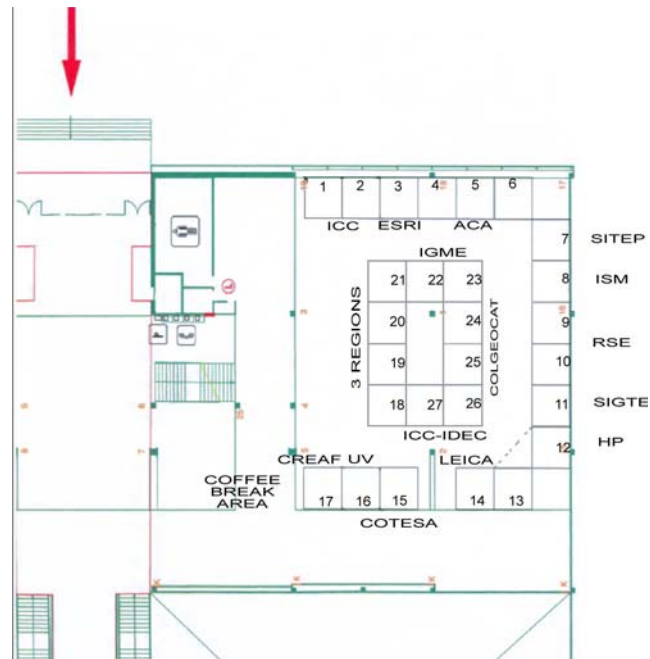

<b>STAND 1 &amp; 2 .</b>	Institut Cartogràfic de Catalunya (ICC)
<b>STAND 3 .</b>	ESRI Europe.
<b>STAND 4 &amp; 5 &amp; 6 .</b>	Agència Catalana de l'Aigua
<b>STAND 7 .</b>	Sistema de Información Territorial y Posicionamiento (SITEP)
<b>STAND 8 .</b>	ISM Europe
<b>STAND 9 &amp; 10 .</b>	RSE Aplicaciones Territoriales S.A.
<b>STAND 11 .</b>	Servei de Sig i Teledetecció Universitat de Girona (SIGTE)
<b>STAND 12 .</b>	Hewlett Packard (HP)
<b>STAND 14 .</b>	Leica geosystems s.l.
<b>STAND 15 .</b>	Cotesa –grupo tecopy
<b>STAND 16 .</b>	Latuv (UV)
<b>STAND 17 .</b>	Centre de Recerca Ecològica i Aplicacions Forestals (CREAF)
<b>STAND 18 &amp; 19 &amp; 20 &amp; 21 .</b>	3 Regions: Emilia-Romagna, Catalunya and Freistaat Bayern
<b>STAND 22&amp;23 .</b>	Instituto Geologico y Minero de España (IGME)
<b>STAND 24&amp; 25 .</b>	Col.legi Oficial de Geòlegs de Catalunya
<b>STAND 26&amp; 27 .</b>	ICC-IDEC

## PROMOTING COMMITTEE

Vasco Errani  
Presidente della Regione Emilia-Romagna

Marioluigi Bruschini  
Assessore alla difesa del suolo e della costa. Protezione civile

Werner Schnappauf  
Bayerischer Staatsminister für Umwelt, Gesundheit und Verbraucherschutz

Pasqual Maragall  
President de la Generalitat de Catalunya

Joaquim Nadal  
Conseller de Política Territorial i Obres Públiques

## SCIENTIFIC COMMITTEE

### **Emilia-Romagna**

Gian Paolo Artioli  
Raffaele Pignone

### **Catalunya**

Xavier Berástegui  
Antoni Roca

### **Freistaat Bayern**

Hubert Schmid  
Ulrich Lagally

### **European Commission**

Luca Montanarella

### **EuroGeoSurveys**

Patrice Christmann

## LOCAL ORGANIZING COMMITTEE

Antoni Roca, Xavier Berástegui, Jordi Cirés, Jorge Fleta, Mariona Losantos, Ana Isabel de Paz

### *Secretariat*

Eulàlia Pujal, Marta Gratacós and Núria Díaz

SCIENTIFIC PROGRAMME

## TUESDAY, 13<sup>TH</sup>

- 9.00 *Registration*
- 15.00 ROOM 5 *Opening Ceremony*  
**Official Opening by the Promoting Committee**  
**Joaquim Nadal**, Conseller de Política Territorial i Obres Públiques and President de l'Institut Geològic de Catalunya  
**Marioluigi Bruschini**, Assessore Sicurezza Territoriale, Difesa del Suolo e della Costa, Protezione Civile  
**Albert Göttle**, Präsident Bayerisches Landesamt für Umwelt
- 15.40 **Presentations and welcome by the Scientific Committee**
- 15.50 Invited lecture:  
**José Pedro Calvo Sorando**, General Director of the Geological Survey of Spain (IGME)  
*Running the 21st Century – Role of Geological Surveys*
- 17.00 Welcome and general remarks by the Local Organizing Committee
- 17.15 Keynote Lectures  
**Morten Smelror**, Director of the Geoscience Division. NGU, Geological Survey of Norway  
*Geology for Society*  
**Luca Montanarella**, Secretary of the European Soil Bureau Network (ESBN). Joint Research Centre. European Commission  
*The establishment of a new European Soil Data Centre in support to the implementation of the EU Thematic Strategy for Soil Protection*  
**Kristine Asch**, Section Head. International and National GIS and Maps. BGR. Federal Institute for Geosciences and Natural Resources, Germany  
*Evolution of Geological Mapping in Europe*  
**Anselm Smolka**, Head of Geophysical and Hydrological Risks. Geo Risks Research Department. Munich Reinsurance Company, Germany  
*Geological Hazards – Causes, Trends and Risk Management*
- 18.45 Welcome drink and opening of the exhibition



## WEDNESDAY, 14<sup>TH</sup>

9.00 ROOM 5 *Session 1*

***Quality and Quantity of Water in the Future***

Chairperson

**Gabriel Borràs**, Agencia Catalana de l'Aigua

ROOM 6 *Session 10.2*

***Maps, Information Systems and New Tools. Information Systems.***

Chairperson

**Kristine Asch**, Federal Institute for Geosciences and Natural Resources (BGR)

ROOM 8 *Session 3*

***Mineral Resources and Geothermal Energy***

Chairperson

**Manuel Regueiro**, IGME

14.35 ROOM 5 *Session 4*

***Climate Change***

Chairpersons

**Stefano Tibaldi**, ARPA

**Agustin Lobo**, IJA - CSIC

ROOM 6 *Session 10.1*

***Maps, Information Systems and New Tools. Maps.***

Chairperson

**Jorge Fernández Gianotti**, IGME

ROOM 8 *Session 11*

***Detection and Monitoring Ground Movements Using Interferometry (DIFSAR) Techniques***

Chairpersons

**Chris Browitt**, University of Edinburgh, School of Geosciences

**Vincenzo Rizzo**, IRPI-CNR

17.00 ROOM 5 *Session 7*

***Geology of Urban Areas***

Chairpersons

**Martin Culshaw**, British Geological Survey (BGS)

**Giuseppe Nardi**, Università di Napoli Federico II

ROOM 6 *Session 10.3*

***Maps, Information Systems and New Tools. New tools.***

Chairperson:

**Jordi Cirés**, ICC

ROOM 8 *Session 6*

***Coastal System Management***

Chairpersons

**Agustí Sánchez Arcilla**, Universitat Politècnica de Catalunya

**Luisa Perini**, Regione Emilia-Romagna

20.00 Social Dinner

## THURSDAY, 15<sup>TH</sup>

- 9.00 ROOM 5 *Session 1 (Cont.)*  
**Quality and Quantity of Water in the Future**  
Chairperson: **Gabriel Borràs**, Agencia Catalana de l'Aigua
- ROOM 5 *Session 2*  
**Soil Conservation**  
Chairpersons: **Luca Montanarella**, CEC JRC and **Jaume Boixadera**, UdL. Dept. Medi Ambient i Ciències del Sòl
- ROOM 8 *Session 13*  
**Policies for dissemination and delivery of geoscientific data**  
Chairperson: **Kristine Asch**, Federal Institute for Geosciences and Natural Resources (BGR)
- 11.15 ROOM 5 *Session 7 (Cont.)*  
**Geology of Urban Areas**  
Chairpersons: **Martin Culshaw** (BGS) and **Giuseppe Nardi**, Università di Napoli Federico II
- ROOM 6 *Session 2 (Cont.)*  
**Soil Conservation**  
Chairpersons: **Luca Montanarella**, CEC JRC and **Jaume Boixadera**, UdL.
- ROOM 8 *Session 13 (Cont.)*  
**Policies for dissemination and delivery of geoscientific data**  
Chairperson: **Kristine Asch** (BGR)
- 14.30 ROOM 5 *Session 6 (Cont.)*  
**Coastal System Management**  
Chairpersons: **Agustí Sánchez Arcilla**, Universitat Politècnica de Catalunya and **Luisa Perini**, Regione Emilia-Romagna
- ROOM 6 *Session 5*  
**Geological Risk Assessment and Security Policies**  
Chairpersons: **Joan Manel Vilaplana**, Universitat de Barcelona (UB)
- ROOM 8 *ROUND TABLE*  
**European Geological Surveys preparing for INSPIRE / Geoscientific Information and Knowledge in Support of E.U. policy making**  
Chairpersons: **Alessandro Annoni**, European Commission TBC, **Patrice Christmann**, EuroGeosurveys and **Ian Jackson** BGS
- 15.35 ROOM 5 *Session 8*  
**Popularization of Geology**  
Chairpersons: **Wim de Gans**, TNO and **Mariona Losantos**, ICC
- 16.35 ROOM 5 *Session 8 (Cont.)*  
**Popularization of Geology**  
Chairpersons: **Wim de Gans**, TNO and **Mariona Losantos**, ICC
- ROOM 6 *Session 5 (Cont.)*  
**Geological Risk Assessment and Security Policies**  
Chairpersons: **Anroni Roca**, IGC
- ROOM 8 *ROUND TABLE (Cont.)*  
**European Geological Surveys preparing for INSPIRE / Geoscientific Information and Knowledge in Support of E.U. policy making**  
Chairpersons: **Alessandro Annoni**, European Commission TBC, **Patrice Christmann**, EuroGeosurveys and **Ian Jackson** BGS
- 17.45 ROOM 5 *Session 12*  
**GeoTourism and heritage**  
Chairpersons: **Ulrich Lagally**, Bayern and **Hans-Peter Schönlaub**

## FRIDAY, 16<sup>TH</sup>

- 9.00 ROOM 5 *Special Session*  
**Cities and their Subsurfaces**  
Chairpersons  
**Wim de Gans**, TNO  
**Giuseppe Nardi**, Università di Napoli Federico II  
**Xavier Berástegui**, ICC
- ROOM 6 *Session 5 (Cont.)*  
**Geological Risk Assessment and Security Policies**  
Chairpersons  
**Joan Manel Vilaplana**, Universitat de Barcelona
- ROOM 8 *Session 9*  
**Remote Sensing Applications**  
Chairpersons  
**Christine King**, BRGM France  
**Friederich Quiel**, KTH (Kungl. Tekniska Högskolan), Sweden
- 11.00 ROOM 5 *Special Session (Cont.)*  
**Cities and their Subsurfaces**  
Chairpersons  
**Wim de Gans**, TNO  
**Giuseppe Nardi**, Università di Napoli Federico II  
**Xavier Berástegui**, ICC
- ROOM 6 *Session 5 (Cont.)*  
**Geological Risk Assessment and Security Policies**  
Chairpersons  
**Joan Manel Vilaplana**, Universitat de Barcelona
- ROOM 8 *Session 9 (Cont.)*  
**Remote Sensing Applications**  
Chairpersons  
**Christine King**, BRGM France  
**Friederich Quiel**, KTH (Kungl. Tekniska Högskolan), Sweden
- 12.00 Closure

TECHNICAL PROGRAMME

ECONGEO2006

ORAL PRESENTATIONS

TUESDAY 13th	ROOM 5
09.00-13.00	Registration
13.00-15.00	LUNCH
15.00-16.30	OPENING CEREMONY
16.30-17.00	COFFE BREAK
17.00-17.15	REMARKS LOC
17.15-18.45	KEYNOTE LECTURES
18.45-20.00	WELCOME DRINK EXHIBITION OPENING

WEDNESDAY 14th	ROOM 5	ROOM 6	ROOM 8
09.00-10.50	Session 1	Session 10.2	Session 3
10.50-11.15 COFFEE BREAK			
11.15-13.00	Session 1 (Cont.)	Session 10.2 (Cont.)	Session 3
13.00-14.30 LUNCH			
14.30-16.35	Session 4	Session 10.1	Session 11
16.35-17.00 COFFEE BREAK			
17.00-18.50	Session 7	Session 10.3	Session 6
20.00-23.30 SOCIAL DINNER			

THURSDAY 15th	ROOM 5	ROOM 6	ROOM 8
09.00-10.50	Session 1 (Cont.)	Session 2	Session 13
10.50-11.15 COFFEE BREAK			
11.15-11.50	Session 7 (Cont.)	Session 2 (Cont.)	Session 13 (Cont.)
11.50-13.00			
13.00-14.30 LUNCH			
14.30-15.35	Session 6 (Cont.)	Session 5	ROUND TABLE
15.35-16:35	Session 8		
16.35-17.00 COFFEE BREAK			
17.00-17.45	Session 8 (Cont.)	Session 5 (Cont.)	ROUND TABLE (Cont.)
17.45-18:10			
18:10-19:40	Session 12		

FRIDAY 16th	ROOM 5	ROOM 6	ROOM 8
09.00-10.30	Special Session	Session 5 (Cont.)	Session 9
10.35-11.00 COFFEE BREAK			
11.00-12.00	Special Session (Cont.)	Session 5 (Cont.)	Session 9 (Cont.)
12.00-13.0 CLOSURE			

ECONGEO2006

POSTER SESSIONS

WEDNESDAY 14th		POSTER EXHIBITION AREA	
09.00-09.30			
09.30-10.00			
10.00-10.30			
10.30-11.00			
11.00-11.30		COFFEE BREAK	
11.30-12.00			
12.00-12.30			
12.30-13.00			
13.00-14.30		LUNCH	
14.30-15.00	Session 1	Session 3	
15.00-15.30			
15.30-16.00			
16.00-16.30	Session 7	Session 6 Session 11	
16.30-17.00		COFFEE BREAK	
17.00-17.30	Session 4		
17.30-18.00			
18.00-18.30			
18.30-19.00			
20.00-23.30		SOCIAL DINNER	

THURSDAY 15th		POSTER EXHIBITION AREA	
09.00-09.30		Session 10.1, Session 10.2 Session 10.3	
09.30-10.00			
10.00-10.30			
10.30-11.00			
11.00-11.30		COFFEE BREAK	
11.30-12.00			
12.00-12.30			
12.30-13.00			
13.00-14.30		LUNCH	
14.30-15.00	Session 8 Session 12	Session 2	
15.00-15.30			
15.30-16.00			
16.00-16.30			
16.30-17.00		COFFEE BREAK	
17.00-17.30			
17.30-18.00			
18.00-18.30			
18.30-19.00			
20.00-23.30			

FRIDAY 16th		POSTER EXHIBITION AREA	
09.00-09.30			
09.30-10.00			
10.00-10.30			
10.30-11.00			
11.00-11.30		COFFEE BREAK	
11.30-12.00	Session 5	Session 9	
12.00-13.00		CLOSURE	

ORAL SESSIONS



5<sup>th</sup>

Barcelona | Catalonia, Spain  
june 13<sup>th</sup> | 16<sup>th</sup> 2006

<b>TUESDAY 13th</b>	
<b>09.00-13.00</b>	<i>Registration</i>
<b>ROOM 5</b>	
15.00-15.40	<b>Official Opening by the Promoting Committee</b> <b>Joaquim Nadal.</b> Conseller de Política Territorial i Obres Públiques and President de l'Institut Geològic de Catalunya <b>Marioluigi Bruschini.</b> Assessore Sicurezza Territoriale, Difesa del Suolo e della Costa, Protezione Civile <b>Albert Göttle.</b> Präsident Bayerisches Landesamt für Umwelt
15.40-15.50	<b>Presentations and welcome by the Scientific Committee</b>
15:50-16:30	Invited lecture: Running the 21 <sup>st</sup> Century. Role of the Geological Surveys, by José Pedro Calvo Sorando. General Director of the Geological Survey of Spain (IGME)
<b>16.30-17.00</b>	<b>COFEE BREAK</b>
17.00-17.15	<b>Welcome and general remarks Local Organizing Committee</b>
17.15-18.45	Keynote lectures <b>Morten Smelror.</b> Director of the Geological Survey of Norway (NGU) <i>Geology for Society</i> <b>Luca Montanarella.</b> Secretary of the European Soil Bureau Network (ESBN). Joint Research Centre. European Commission <i>The establishment of a new European Soil Data Centre in support to the implementation of the EU Thematic Strategy for Soil Protection</i> <b>Kristine Asch,</b> Section Head. International and National GIS and Maps. BGR. Federal Institute for Geosciences and Natural Resources, Germany <i>Evolution of Geological Mapping in Europe</i> <b>Anselm Smolka.</b> Head of Geophysical and Hydrological Risks. Geo Risks Research Department. Munich Reinsurance Company, Germany <i>Geological Hazards – Causes, Trends and Risk Management.</i>
<b>18.45-20.00</b>	<b>WELCOME DRINK AND OPENING OF THE EXHIBITION</b>



WEDNESDAY 14th	ROOM 5	ROOM 6	ROOM 8
09.00-10.50	<b>S1: G. Borràs</b>	<b>S10.2: K. Asch</b>	<b>S3: M. Regueiro</b>
09.00-09.05	<i>Opening statement</i>	<i>Opening statement</i>	<i>Opening statement</i>
09.05-09.20	<b>Marina Aurighi; Franco Cucchi and Luca Zini</b> Deep waters vulnerability of sette comuni plateau, Veneto Region (Italy)	<b>Thierry Kressmann</b> Arts and sciences within a single database	<b>Klaus Poschold and Michael Procher</b> Mapping of raw material areas considering water management needs exemplarily shown by the regional planning of the "Allgäu region"
09.20-09.35	<b>Branka Bračić Železnik</b> Groundwater pollution with TCE-Sanitation planning by using the data base	<b>Mario Sartori; Pascal Ornstein; Cédric Métraux; Lucien Schreiber and Andreas Kuehni</b> From Geological Cartography to Digital Maps: Spatial Data Model and GIS Tool.	<b>Alexander Volkov; Hilmar Thomson; Anatoly Sidorov and Nina Kochneva</b> New methods of construction of the structural-metallogenic maps
09.35-09.50	<b>Ezio Crestaz and Erika Cascelli</b> Density-dependent groundwater flow in water supply and contaminated water containment policies assessment	<b>Kristine Asch</b> Europe's geology on-line: the IGME 5000	<b>Irina Chizhova</b> An integrated representation of geo-knowledge for description and comparison of ore deposits
09.50-10.05	<b>Rocco Favara; Esterina Gagliano Candela; Giovannella Pecoraino; Maria Clara Provenzano; Claudio Scaletta and Maria Anna Schiavo</b> Nitrate contamination in aquifers of Sicily, Italy	<b>Verka Jovanovic and Zoran Srdic</b> How to choose and indicate the business location with GIS	<b>Euvgenia Cheremisina</b> Information and analytical support of nature use problems based on GIS and grid technologies
10.05-10.20	<b>Beatrice Giambastiani; Marco Antonellini and Giovanni Gabbianelli</b> Evaluation of a well-injection recharge system to contrast saltwater intrusion in a coastal forest: the S.Vitale pinewood Ravenna (Italy)	<b>Andreas Kühni; Laurent Jemelin; Nils Oesterling; Mario Sartori and Michel Jaboyedoff</b> Integration of GIS into the geological map production cycle of the Swiss Geological Survey	<b>Leonid Chesalov</b> Situation center for natural resources management
10.20-10.35	<b>Ana Milanovic</b> Water supply problems in Lepenica River Basin (Central Serbia) and possible solutions	<b>Nils Oesterling; Laurent Jemelin and Andreas Kühni</b> Geological Information System of Switzerland – Data Model and Data Viewer	<b>Ubul Fügedi; Tamás Pocsai and László Kuti</b> The "Gyöngyöroszsi pollution" - Effects and solutions
10.35-10.50	<b>Shahab Varkouhi and Ali Uromeie</b> Determination of trace elements in fish tissue at selected sites in the Veysian county	<b>Michele Montaguti</b> Developing the new Geographic Information System for the Servizio Geologico, Sismico e dei Suoli, regione Emilia-Romagna	<b>Kovalevskii A.L. and Kovalevskaya O.M.</b> The relationships between the chemical elements content in plants tissues and in the rootinhabited environment
10.50-11.05	<b>Abderrahmane Melloul; Mimoun Boughriba; Yassine Zarhloule; Maria Snoussi; Mohammed Boufaïda; Abdenbi El Mandour and Probst J. L.</b> A multicriteria approach for detection and mapping of pollution in coastal zone, Morocco	<b>Catherine Satra Le Bris; Serge Berné and Nelly Frumholtz</b> Gulf of lions GIS at Ifremer: from morphobathymetric map to integrated european project.	<b>Dorjnamjaa Dorj; Selenge Dorjnamjaa; Davaadorj Tumurbaatar and Battsagaan Uyanga</b> The exclusive characteristics of the diamond-bearing astropipes in Mongolia
11.05-11.15	<b>COFFEE BREAK</b>		
11.15-13.00	<b>S1 (Cont.): G. Borràs</b>	<b>S10.2 (Cont.): K. Asch</b>	<b>S3: M. Regueiro</b>
11.15-11.30	<b>Attilio Colagrossi; Lorenzo Felli and Giordano Giorgi</b> A Web-GIS Java-Based Tool for Water Quality Reporting and Analysis	<b>M.T. Lamelas; Oswald Marinoni; J. Riva and Andreas Hoppe</b> The use of spatial decision support systems for sand and gravel extraction suitability in the context of a sustainable development in the surroundings of Zaragoza (Spain)	<b>Vladimir I. Vyalov; Idea B. Volkova and Oleg V. Petrov</b> Petrological atlas of fossil organic matter in Russia
11.30-11.45	<b>Ezio Crestaz; Erika Cascelli and Luciano Tabani</b> A brief review of GIScience in groundwater analysis and management	<b>Chiara Calligaris; Alessio Mereu and Luca Zini</b> Prato carnico hydrogeological ground model create to define the dynamic movement that involved the village	<b>Leake Woldegiorgis</b> Geology and the hydrocarbon potential of the eritrean Red Sea basin
11.45-12.00	<b>Rocco Favara; Ester Gagliano Candela; Giovannella Pecoraino; Maria Clara Provenzano and Claudio Scaletta</b> Groundwater monitoring network in the main Sicilian aquifers and GIS application	<b>JaeHong Hwang and KwnagHoon Chi</b> Integration and Analysis of Geologic Map DB in South Korea Using GIS	<b>Ewa Kurowska</b> Cartographic aspects of geothermal exploration in north-west Poland
12.00-12.15	<b>Michael Guenther</b> The water information system "FIS Gewässer" of Thüringen	<b>Navas Madrazo, J. and Sanchez, T.</b> The Badajoz project. Information system for the continuous geological map of Spain	<b>Hendro Wibowo and Emmanuel John M. Carranza</b> Data-driven Evidential Belief Predictive Modelling of Regional-Scale Geothermal Prospectivity in West Java (Indonesia)
12.15-12.30	<b>Consuelo Nicolò; Salvatore Carboni and Antonio Pala</b> 3-D geologic modelling and visualization of the Sinis aquifers (Sardinia, Italy) and a GIS - Based hydrogeologic database for groundwater modelling	<b>Li Chaoling; Yu Qingwen and Yang Donglai</b> Digital Regional Geological Survey Mapping Technique and RGMMap 3.0 System	<b>Leake Woldegiorgis; Michael A. Clyne; Wendell A. Duffield; Robert O. Fourneir; Cathy; J. Janik; G. Kabsai; Jacob B. Lowenstern; K. Weldemariam; James G. Smith and T. Tesfai</b> Geology & geothermal potnetial of northern Danakil depression, Eritrea
12.30-12.45	<b>Giuseppe Sappa and Matteo Rossi</b> Data shared elaboration to irrigation water needs evaluation supported by GIS	<b>Agata Lo Tauro</b> GIS and remote sensing for the implementation of thematic cartography in protected areas	
12.45-13.00	<b>Cibin Ubaldo; Paolo Severi; Andrea Chahoud; Giorgio Frassinetti and Marco Marcaccio</b> Water deficit and subsidence in a intensive-exploited alluvial fan (Reno river, Italy): subsurface hydrogeological analysis to support groundwater resource management	<b>Ulrich Teipel; Ralph Annau and Christian Woelfl</b> You still need a hammer for the rocks, but everything else is digital..."GeoKart" – Application of an expert digital mapping tool	
13.00-14.30	<b>LUNCH</b>		
14.30-16.35	<b>S4: S. Tibaldi and A. Lobo</b>	<b>S10.1: J. Fdez. Gianotti</b>	<b>S11: C. Bowitt and V. Rizzo</b>
14.30-14.35	<i>Opening statement</i>	<i>Opening statement</i>	<i>Opening statement</i>
14.35-14.50	<b>Giovanni Brighenti</b> Carbon dioxide sequestration in geological formation: problems and difficulties	<b>Gáspár Albert; László Orosz and László Gyalog</b> Cartographic representation of geological information, observed on tunnel walls and fronts	<b>Chris Browitt</b> Monitoring millimetric ground movements from space: The ESA GMES TERRAFIRMA project
14.50-15.05	<b>Charlotte Vinchon; Déborah Idier; Manuel Garcin; Yann Balouin; Cyrille Mallet; Luc Closset; Robin McInnes; Jenny Jakeways and Helen Fairbank</b> Mapping the regional impact of climate change on coastal risks	<b>Dorjnamjaa Dorj; Selenge Dorjnamjaa and Davaadorj Tumurbaatar</b> The conception of development of the ecological geology in Mongolia	<b>Xavier Develeschouwer; Pierre-Yves Declercq; Franck Pourie and Estelle Petitclerc</b> Is there a relation between an abandoned underground exploitation of sandy limestones in brussels and subsidence phenomenon revealed by psinars data?
15.05-15.20	<b>Rajib Bhagat; Chitra Sood; Ranbir Singh and Vaibhav Kalia</b> Impact of climate change on water resources of Himachal Pradesh-Himalaya, India	<b>László Gyalog; Károly Brezsnýánszky; Vera Maigut; Ferenc Sikhegyi and Gábor Turczi</b> Data harmonisation in setting up the 1:100 000 geological map series of Hungary	<b>Alessandra Calendino; Pasquale Caruso; Antonio Iodice and Vincenzo Rizzo</b> landslide monitoring for Risk Assessment and managing via Differential SAR Interferometry
15.20-15.35	<b>Tullia Bonomi and Angelo Cavallin</b> Regional climatic change: Impact on groundwater	<b>Darka Mioc; François Anton; Ojaswa Sharma and Feras Al-Obeidat</b> Three dimensional modelling of ocean temperature data	<b>Oscar Mora; Roman Arbiol and Vicenç Palà</b> Advanced DInSAR techniques for monitoring terrain displacements
15.35-15.50	<b>Ravinder Kumar Chaujar</b> Effects of climatic changes on the advance and retreat of the Dokriani Bamak (glacier), Garhwal Himalaya, India	<b>Ángel Salazar and Ángel Martín-Serrano</b> Geomorphological maps and active processes maps: similarities and differences	<b>Silvia Fabbrocino; Riccardo Lanari; Gemma Termolini; Giovanni Zeni and Pietro Celico</b> Hydrogeological analysis of land subsidence in the Sarro river plain (south Italy) observed by Sar
15.50-16.05	<b>Franck Lespinas; Wolfgang Ludwig and Serge Heussner</b> Climatic change and water ressource at regional scale: Recent and future evolution of hydroclimatic conditions in Languedoc-Roussillon area (South-East of France)	<b>Alessandro Sbrana; Italo Giulivo; Lucilla Monti; Alan Deino; Paolo Fulignati; Francesco Giordano; Geoffrey Giudetti; Walter Luperini; Paola Marianelli; Romeo Toccaceli and Marco Vietina</b> Realising the new geological map of Ischia is. (Italy) through a multidisciplinary database	<b>Xavier Develescheouwe; Pierre-Yves Declercq and Franck Pourriel</b> Radar interferometry reveals subsidence in Quaternary alluvial plains related to groundwater pumping and peat layers (Belgium)
16.05-16.20	<b>M. Yolanda Luna and Carlos Almarza</b> Homogeneity and variability of precipitation and temperature time series for climatic homogeneous zones in the iberian peninsula	<b>Martin Schiegl</b> Geological maps – legendtools, styles, fonts for ArcMap™ and geodatabase	
16.20-16.35	<b>Franco Ortolani and Silvana Pagliuca</b> The climatic risk for the circummediterranean sea		
16.35-17.00	<b>COFFEE BREAK</b>		
17.00-18.50	<b>S7: M. Culshaw and G. Nardi</b>	<b>S10.3: J. Cirés</b>	<b>S6: R. Sanchez-Arcilla and L. Perini</b>
17.00-17.05	<i>Opening statement</i>	<i>Opening statement</i>	<i>Opening statement</i>
17.05-17.20	<b>Stefano Albanese; Benedetto De Vivo; Annamaria Lima; Domenico Cicchella; Luca Fedele and Giuseppe Grezzi</b> The geochemical environmental atlases of major urban areas of Campania region (Italy).	<b>Pau Arbués; Oscar Fernández; Oriol Falivene; Josep Anton Muñoz and Mariano Marzo</b> Towards 3-D geologic maps. An example of a faulted, folded, and complex stratigraphy	<b>Vincenzo Liguori; Giorgio Manno and F.M. Tobia</b> Integrated management of Marsala coast (Sicily): Application of a new evaluation method
17.20-17.35	<b>Francesco La Vigna; Sara Taviani and Roberto Mazza</b> Hydrogeology of north-east of Rome: The Aniene river basin	<b>Ian Jackson</b> Bridging the gap - how new systems and tools can reach out to new users and add value	<b>Ferraro Luciana; Alberico Ines; Lirer Fabrizio; Sgarrella Franca and Smedile Alessandra</b> GIS application for distribution of recent benthic foraminifera along the Campanian coast (southern Tyrrhenian sea, Italy)
17.35-17.50	<b>K.S. Patel; V.K Jena and S. Chikhalikar</b> Micronutrient Disorder in urban soil	<b>Janusz Magiera</b> Quantitative analysis of the DEM: Detection of the Planation surfaces in the Mountains	<b>Livio Rossi and Fabio Volpe</b> High-resolution satellite data for coastal analysis
17.50-18.05	<b>Antti E.K. Ojala; Heikki Vanhala; Jukka-Pekka Palmu; Ossi Ikävalko and Petri Lintinen</b> Combining geophysical, sedimentological and geotechnical information to characterize geological history of suurpelto construction site in Espoo, southern Finland	<b>Yusupov R., Boldyrev I.; Dobretsov N.N., Klerkx J.; Kolobova Sv.; Dimitrov L. and De Batist M.</b> Functionalities for data processing and visualisation within a database, as a tool for environmental purposes (monitoring)	<b>Jorge Brenner; José A. Jiménez and Rafael Sarda</b> Identification of homogeneous environmental management units as a management tool for the catalan coast
18.05-18.20	<b>M. A. Rodríguez Sastre ; K.J. Northmore; D. C. Entwisle; P. D. Jackson and L. Nelder</b> Geotechnical characterization of loessic brickearth deposits at Faversham, Kent, UK	<b>Oriol Monserrat; Piotr Jaszczak; Michele Crossetto; David Garcia; Antonio Abellán; Jaume Calvet and Joan Manuel Vilaplana</b> Quality assessment of terrestrial laser scanning observations for deformation studies	<b>Laura Caruso; Andrea Minchio; Marcella Sabia; Francesco Stecchi; Marco Antonellini and Giovanni Gabbianelli</b> Coastal dunes as a resilient factor: a new challenge for coastal system management
18.20-18.35	<b>Andrey Antsiferov; Olexandr Glukhov and Vadim Antsiferov</b> Experience in solving problem to control surface subsidence displacement in urban areas on the basis of the special-purpose geoinformation system "geo-mark"	<b>Juan J. Ruiz Lendinez; Antonio Mozas Calvache; Francisco J. Ariza López and Alan D.J. Atkinson Gordo</b> Sample design criteria and GPS acquisition of linear elements for use in positional quality control in cartography	<b>Luisa Perini and Ubaldo Cibin</b> Tools supporting coastal management in Emilia-Romagna (Italy): The Coast Information System and new monitoring programmes (LIDAR & SAR)
18.35-18.50		<b>Peter A. Shary; Olga Mitusova; Andrey V. Mitusov and Larisa S. Sharaya</b> Sustainability of topographic attributes to land surface formation	
20.00-23.30	<b>SOCIAL DINNER</b>		

THURSDAY 15th	ROOM 5	ROOM 6	ROOM 8
09.00-10.50	<b>S1 (Cont.): G. Borrás</b> <i>Opening statement</i>	<b>S2: J. Boixadera and Luca Montanarella</b> <i>Opening statement</i>	<b>S13: K. Asch</b> <i>Opening statement</i>
09.05-09.20	<b>Bouezmarni Mohamed; Dossin Frédéric; Habils Frédéric; Rekk Samantha; Ruthy Ingrid and Sorel Aurélie</b> Hydrogeological mapping of the wallon region (Belgium)	<b>Panos Panagos; Marc Van Liedekerke; Nicola Filippi and Luca Montanarella</b> Towards a new Multi-scale European Soil Information System (MEUSIS)	<b>Zhang Minghua; Qiherige Lee; Deng Zhiqi; Zhang Hong and Wang Chengxi</b> Geo-data Production and Dissemination in China Geological Survey
09.20-09.35	<b>Andreas Hoppe; Christian Lerch and Stefan Lang</b> Detailed estimates of groundwater vulnerability using three dimensional geological models	<b>I. Melendez-Pastor; J. Navarro-Pedreño; I. Gómez; J. Mataix and M.M. Jordán</b> A simplified fuzzy logic model to evaluate soil vulnerability. 1. theoretical basis: dem and remote sensing.	<b>Ru Xianglan and Zhang Hong</b> Administration and Service of Geological Data in China
09.35-09.50	<b>Marelys Mujica; Gabriela Espinosa; Jordi Grifoll and Francesc Giralt</b> Self-organizing groundwater vulnerability maps	<b>J.M. Soriano; I. Melendez-Pastor; J. Navarro-Pedreño; I. Gómez and J. Mataix-Solera</b> A simplified fuzzy logic model to evaluate soil vulnerability. 2. Application to a post-fire study of soil vulnerability in the Paraje of "La Granadella" (Alicante).	<b>Xiongwei Hu; Zhiqi Deng; Yulong Li; Jingchao Li and Hong Zhang</b> Discussion on geo-scientific data services in China geological survey: concepts and infrastructure
09.50-10.05	<b>Enric Queralt; Miquel Vilà; Vinyet Solà and Xavier Berástegui</b> The hydrogeological map of the Llobregat alluvial and deltaic plain (Barcelona urban area). Geology for groundwater management in a strongly anthropised area	<b>Devis Bartolini; Costanza Calzolari; Fabrizio Ungaro; Nicola Laruccia and Marina Guermandi</b> Towards the application of the new Common Agricultural Policy (Reg.1782/2003): analytical and previsional tools for the assessment of soil erosion in the hills of Emilia Romagna.	<b>Asavin M; Nikita Shulga; Vladimir Riachovsky M and Helen Chesalova I.</b> Joint Geo-informational web-portal of Russian Academy of Sciences
10.05-10.20	<b>Giovanni Testa; Enrico Bartoletti; Giovanni Bracci; Mariangela Della Maggese and Claudio Rucci</b> Monitoring surface and ground water of a river basin as the first step towards a sustainable water management	<b>Angel Marqués; Juan M. Gisbert; Sara Ibáñez and Héctor Moreno</b> Procedures and tools for loading soil data in geographic information systems	<b>Thomas Gülden</b> Management of geoscientific data in Bavaria
10.20-10.35	<b>Luigi Tosi; Federica Rizzetto; Pietro Teatini and Laura Carbognin</b> Saltwater intrusion in the southern catchment basin of the Venice lagoon, Italy	<b>Panos Panagos; Marc Van Liedekerke and Luca Montanarella</b> European soil portal: soil data sharing in Europe	<b>Ian Jackson</b> The pros and cons of operating data access in a cost-recovery mode
10.35-10.50		<b>Paola Tarocco; Paolo Conci; Francesca Sapio and Cristina Bizzarri</b> An Innovative WEB Based XML Tool To Manage EMILIA-ROMAGNA Soil Data	<b>Jurian Hoogewerff; Simon Kelly and the TRACE Project Consortium</b> Global Food Forensics, combating geographical origin labelling fraud with spatial geo-scientific information
10.50-11.05		<b>Jaume Porta; Miquel Aran; Jaume Boixadera; Marta López-Acevedo; Núria Llussà; Rosa M. Poch; M. Rosa Teira and J.M. Villar.</b> Web site to access soil information for catalonia and the balearic islands: the sòls-iec web site	<b>M. Alfinito; A. Fiduccia; C. Terranova and A. Risi</b> A regional experience of integration between open platforms and costs solutions: A geoport and webgis application services based on open source systems and software
11.05-11.15	<b>COFFEE BREAK</b>		
11.15-13.00	<b>S7 (Cont.): M. Culshaw and G. Nardi</b>	<b>S2 (Cont.): J. Boixadera and Luca Montanarella</b>	<b>S13 (Cont.): K. Asch</b>
11.15-11.30	<b>Josep Maria Casas; Oscar Gratacós; Montserrat Liesa; Josep Anton Muñoz; Francesc Sàbat; Pere Santanach; Joan Aranda; Enric Vázquez; Jesús Carrera; Jordi Font; Albert Martínez; Arnau Céspedes and Oriol Riba</b> Doing geology in an urban area: Barcelona hills	<b>Alessandro Amorosi; Irene Sammartino; Marina Guermandi and Nazaria Marchi</b> Soil -and geologically- oriented geochemical maps: a pilot study from the southern margin of the Po plain (Parma province)	<b>A. Tchistiakov; J. Jellema; B. Cannell; H. Preuss; T. Hernandez Diaz; D. Capova; J. Belickas; V. Rapsevicius; T. Mardal and P. Peroni</b> eEarth: a New Tool for Multilingual Borehole Data Browsing across the Europe
11.30-11.45	<b>Isabel Duarte; António Pinho and Fernando Ladeira</b> Engineering geological mapping applied to the regional and	<b>El Mostafa Bachaoui; Bahija Bachaoui and Abderrazek El Harti</b> Cartography of soils exposed to water erosion in the Atlas Mountains of Beni Mella city (central of Morocco).	<b>Katrien De Nil; Desirée Uitevilligen; Koenraad Boel; Ilse Vergauwen; Paul De Schrijver and Marleen Van Damme</b> Sustainable evolution of the database of the subsoil of Flanders (DOV): an integrated GIS-application based on map services and on-line data management
11.45-12.00	<b>Hannu Idman; Petri Lintinen and Keijo Nenonen</b> Application of geological maps in land-use planning in Finland	<b>Gianluca Cuzzo; Vittorio Alessandro Marrone; Massimiliano Orrù and Andrea Vacca</b> Mapping soil units at field scale using electromagnetic induction	<b>Kristine Asch</b> The Issues Related to Dissemination of a Pan-European Dataset
12.00-12.15	<b>Jaana Jarva; Petri Lintinen and Heikki Säävuori</b> Construction suitability maps - A tool for general land use planning	<b>Xavier Martínez-Lladó; Miquel Vilà; Miquel Rovira; Vicenç Martí; J. De Pablo; Mariona Losantos and Xavier Berástegui</b> Assessing trace element distribution in natural Top-Soils with geological maps: Catalonia case study	
12.15-12.30	<b>A. Sbrana; I. Giulivo; L. Monti; G. D'Elia; P. Miraglino; F. Giordano; R. Isaia; W. Luperini; L. Perrotta; A. Scarpati; R. Toccaceli and M. Vietina</b> The geology of Naples megacity in the framework of the new geological survey of Naples sheet (CAR.G. Project)	<b>Slobodan Miko; Zoran Peh Ozren Hasan; Martina Šparica Miko; Saša Mesić and Dragan Bukovec</b> Geochemical mapping of topsoil in Croatian karst: provenance implications and pollution signatures	
12.30-12.45	<b>Gangyi Zhai Zit Du</b> 3-Dimensional Urban Geological Survey Serving the Sustainable Development of Cities In China	<b>Raimo Nevalainen; Tapio Väänänen and Harri Lilja</b> The new general scale quaternary deposit digital mapping program in Finland, data for land use planning, soil conservation and soil mapping	
12.45-13.00		<b>Samira El Bahi, M. Yassin, and M. El Wartiti</b> Applying revised universal soil loss equation model to forest land in Central Plateau of Morocco	
13.00-14.30	<b>LUNCH</b>		
<b>ROUND TABLE.</b> <b>A. Annoni, P. Christmann and I. Jackson</b>			
14.30-15.30	<b>S6 (Cont.): R. Sanchez-Arcilla and L. Perini</b>	<b>14.30-19.00</b>	<b>S5: J.M. Vilaplana and A.Roca</b>
14.30-14.45	<b>Roberto Cintolo; Giorgio Infuso; José Ángel Martínez del Pozo; Vincenzo Liguori and Giorgio Manno</b> Vulnerability assessment of a coastal sector in south Sicily (Italy)	14.30-14.35 <i>Opening statement</i>	14.00-14.05 <i>Opening Statement (A. Annoni)</i>
14.45-15.00	<b>Masmoudi S.; Howa H.; Yaïch C., Khelifi I. and Yamoun M.</b> Sand mobility along the oriental coastline of Jerba island (Tunisia)	14.35-14.50 <b>Václav Němec</b> Geoethical dimension of the geological risk assessment	14.05-14.15 <b>A. Annoni.</b> Current status, perspectives of the INSPIRE legislative process and impacts on geological information systems.
15.00-15.15	<b>Marco Stefani</b> Understanding the dynamic interaction between fluvial sedimentation and the urban growth of Ferrara (Italy) through stratigraphic analysis and geological mapping	14.50-15.05 <b>Pere Oller; Jordi Marturià; Juan Carlos González and Pere Martínez</b> The avalanche cartography of Catalonia. A preliminary evaluation of the spatial avalanche data	14.15-14.25 <i>Discussion</i>
15.15-15.30	<b>Crescenzo Violante; Giovanni de Alteriis and Eliana Esposito</b> Seafloor base maps, geological features and hazard assessment in marine coastal areas. Examples from the Bay of Naples, Campania, Southern Italy	15.05-15.20 <b>Philipp Schmidt-Thomé; Johannes Klein and Kaisa Schmidt-Thomé</b> Hazard patterns and hazard related project activity analysis to support funding programmes	14.25-14.40 <b>I. Jackson.</b> INSPIRE: are European Geological Surveys ready?
15.30-17.45	<b>S8: W. De Gans and M. Losantos</b>	15.20-15.35 <b>Ciotoli G.; Lombardi S.; Vitale V. and Annunziatellis A.</b> GIS Applications to Radon Hazard Studies - An Example from the city of Rome (Italy)	14.40-14.50 <i>Discussion</i>
15.30-15.35	<i>Opening statement</i>	15.35-15.50 <b>IONUT Iosifescu-Enescu; Andreas neumann; Radu Gogu and Lorenz Hurnl</b> Learning platform for GIS-based natural hazards mapping	14.50-15.00 <b>P. Ryghaug.</b> Drafting the INSPIRE Implementation Rule on Metadata: progress and issues seen from a Geological Survey perspective.
15.50-16.05	<b>Stefan Glaser and Ulrich Lagally</b> Geo-knowledge for everybody-How to reach the customer	15.50-16.05 <b>Sara Figueras; Mar Tapia and Antoni Roca</b> The influence of local geology on seismic ground motion predictions in Volvi valley test area (Greece)	15.00-15.10 <b>K. Asch or U. Maurer-Rurack.</b> Drafting the INSPIRE Implementation Rule on Data specifications: progress and issues seen from a Geological Survey perspective.
16.05-16.20	<b>Manu Gomez; Eduard Rubio and Jordi Diaz</b> GeoMarCD: Marine Geosciences outreach multimedia CD-ROM	16.05-16.20 <b>Lorenzo Delmaschio; Giampiero Gozza; Sara Pignone and Marco Pizzolo</b> Determination of rainfall thresholds for triggering landslides in the Emilia Apennines	15.10-15.20 <b>F. Robida or J-J. Serrano.</b> Drafting the INSPIRE Implementation Rule on Network Services: progress and issues seen from a Geological Survey perspective.
16.20-16.35	<b>Giovanni Bertolini; Maria Carla Centinno and Raffaele Pignone</b> Geological maps for the general public: the Emilia-Romagna experience	16.20-16.35 <b>Karl Mayer; Katja Müller-Koch and Andreas von Poschinger</b> Danger maps for rock falls in the western Bavarian Alps (Oberallgäu)	15.20-15.30 <b>I. Jackson.</b> Drafting the INSPIRE Implementation Rule on Data sharing and re-use: progress and issues seen from a Geological Survey perspective.
16.35-17.00	<b>COFFEE BREAK</b>		
<b>ROUND TABLE (Cont.)</b> <b>A. Annoni, P. Christmann and I. Jackson</b>			
17.00-17.15	<b>M. Losantos; L. Planagumá; J.Piñan; A. De Paz, C. Puig and E. Bassols</b> The geological chart of the volcanic zone of La Garrotxa Natural Park	17.00-17.15 <b>Adnan Aydin and Yanrong Li</b> Landslide susceptibility evaluation and mapping: a case study	16.10-16.20 <b>P. Christmann.</b> The Global Earth Observation System of Systems programme: implications for Geological Surveys
17.15-17.30	<b>Manjit Kumar Mazumdar</b> Blending geo-education with geoheritage and geotourism for popularizing geosciences – a case study from Assam, northeast India.	17.15-17.30 <b>Nicola Dall'Olio; Enrico De Francesco and Michele Vittorio</b> Sharing and Updating Landslide Maps Using a WebGIS System	16.20-16.30 <i>Discussion</i>
17.30-17.45	<b>Ian Jackson</b> Britain beneath our feet: unlocking digital geoscience data	17.30-17.45 <b>Xavier Mir-Pellicer and Koen Verbruggen</b> Landslide susceptibility mapping in north west Ireland using GIS and spatial analysis	16.30-16.40 <b>F. Robida.</b> Towards a global geological data model: activities of the International Union of Geological Sciences Commission for the Management and Application of Geoscience Information
17.45-19.20	<b>S12: U. Lagally and H.P. Schönlaub</b>	17.45-18.00 <b>J.Sepúlveda and M. Mendizabal</b> GIS, probability and cost-benefit analysis of the natural risks: a new point of view for the landslides and rock falls	16.40-16.50 <i>Discussion</i>
17.45-17.50	<i>Opening statement</i>	18.00-18.15 <b>Nicolas Parubets</b> The 2005 Modification of GIT Geological Map of the Ocean Floor – an Effective Tool for the Prediction of the Most Powerful Earthquakes	16.50-17.00 <b>F. Robida.</b> The ORCHESTRA Project
17.50-18.05	<b>Ewa Malgorzata Welc</b> The geotourist Range - The chance of local heritage protection	18.15-18.30 <b>Ana Costa; Ricardo Caranova; João Cabral and Sandra Silva</b> The Ponsul Fault - An example from the seismotectonic GIS of mainland Portugal	17.00-17.10 <i>Discussion</i>
18.05-18.20	<b>Franz Pertlik</b> Historical and cultural recovery of the salt mine in Hall in Tyrol	18.30-18.45 <b>Friedrich Quiel</b> Modelling propagation of train induced ground vibrations in a geographic information system	17.10-17.20 <b>K. Asch.</b> Establishing policy based on evidence: Can a pan-European mapping project assist in developing plans for a European geoscience spatial data infrastructure?
18.20-18.35	<b>Joan Santacana; Núria Serrat and Gonzalo Riba</b> Trempl, a geological eye to the world: A project designed to present and interpret geological heritage	18.45-19.00 <b>Antonio Giuffrida and Agata Lo Tauro</b> Geographic Information System for the Hazard Assessment: The Etna Plan	17.20-17.30 <i>Discussion</i>
18.35-18.50	<b>Hans P. Schönlaub</b> Earth sciences at crossroads – geoparks, geotourism and geo@venture in Austria		17.30-17.40 <b>J. Guimet.</b> Putting the Catalonia Geological Survey Information System in the SDI framework: "We are not alone".
18.50-19.05	<b>Paula Urrutia</b> Natural, geological and cultural itineraries and rural tourism, in Baja California Sur, as a way towards sustainable development		17.40-17.50 <i>Discussion</i>
19.05-19.20	<b>Dr. Niranjan Kumar Das and Manjit Kumar Mazumdar</b> Cave tourism in Meghalaya, northeast India – a prospective geotourism initiative for geoheritage conservation		17.50-18.10 General discussion on the need for future action at the European and Global scales
			18.10-18.25 <i>Concluding statements by the Chair</i>



Barcelona | Catalonia, Spain  
June 13<sup>th</sup> | 16<sup>th</sup> 2006

FRIDAY 16th	ROOM 5	ROOM 6	ROOM 8
<b>09.00-10.35</b>	<b>SS: W. De Gans, G. Nardi and X. Berástegui</b>	<b>S5 (Cont.): J.M. Vilaplana and K. Fabbri</b>	<b>S9: A. Bjorlykke, C. King and F. Quiel</b>
09:00-09:05	<i>Opening statement</i>	<i>Opening statement</i>	<i>Opening statement</i>
09:05-09:20		<b>Ridha Maamri; Mourad El Koundi; El Mabrouk Essid; Adel Sghaier; Mustapha Ben Haj Ali and Fouad Zargouni</b> Impact of anthropologic factors on the environment: fitting out the sabkha of Sejoumi (Tunisia)	<b>El Archi</b> The optical teledetection, interferometry radar and SIG application for the geological risks determination, the planning and the construction of a road network in the High Atlas, Morocco
09:20-09:35		<b>Claudia Meisina</b> Thematic maps to investigate the causes of building damage: the case study of Oltrepo Pavese (Northern Italy)	<b>Jordi Marturià; Oscar Mora; Daniel Xifre; Pere Martinez and Antoni Roca</b> DInSAR techniques versus high topographic leveling surveys: The subsidence phenomena in Sallent
09:35-09:50		<b>Manuel Moya and Fernando Ladislao Moreno</b> Assessment of wild-land fire risk in the wildland-urban interface of three villages of Extremadura (Spain)	<b>Shawn C. Kefauver; Jonathan Greenberg and Susan L. Ustin</b> Remote Sensing of Tropospheric Ozone Impacts on Bio-Indicator Species Using Imaging Spectroscopy
09:50-10:05	SPECIAL SESSION: CITIES AND THEIR SUBSURFACES	<b>Antonio Paglionico; Domenico Schiavone and Donato Sollitto</b> The asbestos pollution in an urban system: an abandoned factory in the town of Bari (southern Italy)	<b>Guillaume Martelet; Bruno Tourlière; Catherine Truffert and José Perrin</b> Airborne radiometry and magnetics help mapping potential groundwater resources in a weathered basement environment, French Guiana
10:05-10:20		<b>C.S. Oliveira; M.A. Ferreira and F. Mota de Sá</b> Applications of GIS on defining Earthquake Scenarios cases in Portugal	<b>Ji Wei</b> Landscape effects of urban sprawl: spatial and temporal analyses using remote sensing images and landscape metrics
10:20-10:35		<b>Jordi Marturià; Jesus de Diego; Pere Martinez and Antoni Roca</b> Implementation of a Subsidence Risk Management System	<b>Karen St. Seymour; Maria Kouli; Dimitrios Zouzias; George Papaioannou and Costas Vamvoukakis</b> Identifying calderas in Aegean Sea, Hellas, using remote sensing techniques
<b>10.35-11.00</b>	<b>COFFEE BREAK</b>		
<b>11.00-11.30</b>	<b>SS (Cont.): W. De Gans, G. Nardi and X. Berástegui</b>	<b>S5 (Cont.): J.M. Vilaplana and K. Fabbri</b>	<b>S9 (Cont.): A. Bjorlykke, C. King and F. Quiel</b>
11:00-11:15		<b>Francesco Stecchi and Francesco Mancini Giovanni Gabbianelli</b> G.I.S. as a tool for data management and ground deformations analysis in the city of Tuzla (BIH)	<b>Dominique King; Yves Le Bissonnais; Olivier Cerdan; Christine King; Guy Richard and Veronique Souchère</b> Origin and specificity of the stream model (Sealing and Transfer by Runoff and Erosion related to Agricultural Management)
11:15-11:30	SPECIAL SESSION: CITIES AND THEIR SUBSURFACES	<b>Pushkar K Pradhan</b> Flood Disaster in the Lower Karnali River Basin, West Nepal	<b>Paulo Roberto Markoski and Silvia Beatriz Alves Rolim</b> Mapping amethyst mineralizations using classification techniques in aster images: a case study in ametista do Sul, Rio Grande do Sul state, Brazil
<b>12.00-13.00</b>	<b>CLOSURE</b>		

POSTER SESSIONS



POSTER SESSIONS - JUNE 14<sup>th</sup>

Session 1 QUALITY AND QUANTITY OF WATER IN THE FUTURE		
Day_Poster#	All_authors	Title
14_02	Erika Bodnár and Géza Chikán	Impact of open-pit gravel mining on the groundwater level of a small region
14_03	Daniele Bonaposta and Maria Teresa De Nardo	Thematic mapping on groundwater chemistry: first results pertaining to springs in the reggio-Emilia Apennines (northern Italy)
14_04	Gian Luca Bufacchi; Lucio Martarelli and Anna Rosa Scalise	The hydrogeological role of the flysch formations in the Sabatini and Vicani mts volcanic districts (Lazio, central Italy)
14_05	Cerrina Feroni Andrea; Ellero Alessandro; Levi Nicola; Oltría Giuseppe; Pardini Elena and Pei Alessandra	A structural geological approach for the exploitation of groundwater resources in buried rock aquifers: the experience of the Tuscany region (Italy)
14_06	Wolfgang Czegka	Remote Sensing and GIS Data as basis for a "Quasi-Temporal GIS" for hydrochemical parameters in the new Central German lake district
14_07	Maria Teresa De Nardo; Thomas Gemelli; Giulio Panini; Maurizio Pellegrini and Stefano Segadelli	Experimentation for a quantitative hydrogeological map in a mountain area: a case study in the region Emilia Apennines (northern Italy)
14_08	Juliana Delgado; Pilar Llorens; Francesc Gallart and Ian Calder	Simulating the water balance at the headwater catchments of the Llobregat river (NE Spain) under possible land cover changes
14_09	Albert Folch; Anna Menció and Josep Mas-Pla	Relevance of vertical ground water recharge through faults in tectonic basins
14_10	Gogo Gjivoqi; Hamdi Beshku; Xhume Kumanova and Aranit Gelaj	Evaluation of Hydro geological map of Albania by Hydro geological Map of Europe
14_11	Javier González González	Flood maps for urban planning
14_12	Floyd Gray; William R. Page; Laura M. Norman; Jesus Jaime Castro Escarrega; Jean Parcher and Leila Gass	Geologic Framework Studies and Geospatial Analysis of Change in Support of Hydrologic Modelling and Environmental Health Studies in the U.S.-Mexico Border Region
14_13	Gazi Anisur Rahman and Prosun Bhattacharya	(Application of Pqis for the) Spatial Distribution of Arsenic Free Deep Tube-wells -A study on Matlab Thana of BANGLADESH
14_14	M. Hamidur Rahman and Hiroaki Ishiga	Arsenic pollution in groundwater of Bangladesh
14_15	Katarina Hribernik	Datamodel of national hydrogeological database to define groundwater bodies of Slovenia
14_16	Xhume Kumanova; Nazmie Puca and Albert Avxhi	Ground waters of Korça and Elbasani, hydrochemical data of region part of midle and south-east of Albania
14_17	Ozren Larva; Zeljka Brkić; Tamara Marković and Mario Dolić	Groundwater protection zones of the pumping site Trstenik - Croatia
14_18	Marcin Mazurowski and Malgorzata Schiewe	Hydrogeological conditions of the Lower Warta river valley (Western Poland)
14_19	Anna Menció; Albert Folch and Josep Mas-Pla	Hydrochemical mapping of fluoride occurrence in groundwater in the Selva basin (NE Spain)
14_20	Dimitra Rapti-Caputo; Francesco Sdao; Thomai Sklirou and Stefania Pascale	Evaluation of the pollution risk of the groundwater due to landfill in karstic areas of Kerkyra Island (Greece)
14_21	Shershnev Oleg, V.	Regional hydrogeological and ecological division (within the southeastern of Belarus)
14_22	H. Sadeghi and F. Khosrvi	Influence of joint in the phenomena of solubility of carbonate rocks
14_23	Giovanni Sarti; Margherita Aguzzi; Amorosi Alessandro; Marianna Ricci Lucchi and Stefano Claudio Valani	An integrated approach to aquifer characterization from lower Arno plain (Tuscany, Italy)
14_24	Francesco Sdao and Aurelia Sole	Water framework directive: a study case of water bodies survey
14_25	Stefano Segadelli and Paolo Vescovi, with contributions of Maria Teresa De Nardo and Annalisa Parisi	A pilot study of an ophiolite aquifer within the Emilia-Romagna apennines: The Monte Nero, Parma and Piacenza provinces
14_26	Robert O. Strobl and Paul D. Robillard	Methodology for the identification of critical stream sampling points for the assurance of future water quality
14_27	Liliana Teruggi; Elisabetta Cavigli; Alessio Turi and Enrica Caporali	A geographic information system for the hydrological analysis and river dynamics characterization of the Rio Quequen Grande in Argentina
14_28	Miguel del Pozo; Alfredo García & Leticia Vega	The hydrogeological mapping of the Geological and Mining Institute of Spain: from the paper to the net
Session 3 MINERAL RESOURCES AND GEOTHERMAL ENERGY		
Day_Poster#	All Authors	Title
14_29	Alli I. Al-Juboury	Surface texture on heavy minerals in the miocene-recent sediments from northern Iraq
14_30	Alli I. Al-Juboury	Some aspects on heavy minerals enrichment from recent fluvial sediments, northern Iraq
14_31	Roland Becker; Nicola Hug; Wolfgang Liedmann and Fred Rosenberg	Sustainable protection of near surface raw materials in Hesse, Germany
14_32	Behzad, Hajjalilou	Investigation of mineral resource in alkaline rocks from islami peninsula in Urmieh lake
14_33	Galina A. Belenitskaya; Vladimir I. Vyalov and Oleg V. Petrov	Map of Oil-Gas-bearing of the Russian Federation Territory on the Litho-geodynamic Principle
14_34	Cui Bin; He Zhijun and Zhao Lei	Research on Metallogenic Systems and Prognosis of Gold and Copper Deposits in the Middle Section of Eastern Tianshan, Xinjiang, China
14_35	Xavier Devleeschouwer; Cyril Mullard; Laurent Valepyn and Eric Goemaere	Underground slate vein exploitations (Bertrix, Belgium): from "mining" plans to digital georeferenced 3D model
14_36	Mustafa Faruk and Kaza Nikoll	Petrologic and metallogenic features of volcanics of the ophiolites of Albania
14_37	Anna Lyubimova	Geo-ecological modeling for analysis of ways of a deposit's exploration
14_38	M.G. Manca and M. Palomba	Application of the geographic information system techniques in the field of mineral resources: the case study of albite mineral deposit from central Sardinia (Italy)
14_39	Petraq Naço; Aleksander Cina and Enton Bedini	Geothermal Energy in Albania
14_40	Maja Poznanović; Pavle Tancic and Srebrenka Petrovic	Mineralogically-chemical characteristics of the healing mud from the Koviljaca spa (west Serbia)
14_41	K. Stafeev; T. Janbukhtin; V. Aliskerov and M. Komarov	Geological-and-economic maps while planning the mineral raw material base of the Russian Federation
14_42	Basem Ahmed Zoheir	Shear-related, vein-type gold deposits in Egypt: Fault/fracture- controls on mineralization, a case study from the Barramiya mine area
Session 4 CLIMATE CHANGE		
Day_Poster#	All Authors	Title
14_43	Valerio Buonomo; Franco Ortolani and Silvana Pagliuca	Climate change and beaches destruction in the Mediterranean area
14_44	Valerio Buonomo; Franco Ortolani and Silvana Pagliuca	Proposal of lasting beaches geo-environmental restauration in Campania region in the present period of climatic transition
14_45	Javier Chueca Cia and Asunción Julián Andrés	Cartography of permafrost distribution in the Sierra de Telera (Central Pyrenees, Spain) by using a GIS modelling approach
14_46	Giancarlo De Lisi; Franco Ortolani and Silvana Pagliuca	Geo-environmental modifications in the area affected by the "original" 26 January 2003 Biferno River flood (Molise, Southern Italy)
14_47	Nelly Frumholtz; Catherine Satra Le Bris; Serge Berné and all the partners of PROMESS1 project	Utilization of a GIS in the framework of a european drilling project: The PROMESS1 operation in the Gulf of Lions
14_48	Franco Ortolani and Silvana Pagliuca	Geological evidences of Cyclical Climatic changes and catastrophic events in the Neapolitan urbanised area
14_49	Franco Ortolani and Silvana Pagliuca	Impact of climate change on water resources in Southern Italy
14_50	Juan Carlos Peña Rabadán; Carlos Garcia Sellés; Pere Esteban Vea; Gloria Martí Doménech and Marc Prohom Duran	Recent decrease of temperature over the Eastern Pyrenees and its relationship with the atmospheric circulation: Preliminary results
Session 6 COASTAL SYSTEM MANAGEMENT		
Day_Poster#	All Authors	Title
14_51	Lorenzo Calabrese; Samantha Lorito; Ubaldo Cibin and Luisa Perini	Physical classification of the northern Adriatic coast (Emilia-Romagna Region, Italy) based on geomorphology, land use and coast line changes
14_52	Paolo Ciavola; Luisa Perini; Paolo Luciani and Clara Armaroli	An application of terrestrial lidar surveys for the evaluation of dune erosion generated by storm events
14_53	Rocco Favara; Esterina Gagliano Candela; Giovannella Pecoraino; Maria Clara Provenzano and Claudio Scaletta	Hydrogeological and hydrogeochemical characterization of the main coastal sicilian aquifers
14_54	G. Fontolan; A. Bezzi; S. Pillon; A. Vitturi and V. Bassan	A geodatabase for coastal vulnerability assessment, Venice province, Italy
14_55	Ouardi Z.; Younsi A.; Lhadi E.K.; Mania J. and Chofqi A.	State of the environmental ecosystems of the coastal zone ranging between Bir Jdid and Jorf Lasfar (Province of El Jadida, Morocco)
14_56	Daniela Ruberti; Carmela d'Angelo; Giovanna D'Ambrà; Maria Petriccione; Luisa Palumbo; Rosa Verde and Marco Vigliotti	Integrated Management of the Coastal Areas: realization of a geodatabase for the analysis and the monitoring of the Domitia coastal setting (Southern Italy)
14_57	Josip Terzić; Mario Dolić; Tatjana Vlahović and Tamara Marković	Sanitary protection zones on karstified island of Korčula in Croatia
14_58	Oleg V. Petrov, Daria V. Ryabchuk, Mikhail A. Spiridonov and Vladimir A. Zhamolda	Geological basis for the integrated coastal zone management in condition of hazardous geodynamic processes
Session 7 GEOLOGY OF URBAN AREAS		
Day_Poster#	All Authors	Title
14_59	Mohamed Alaoui; Lahacen Asebriy; Carla Bucci; Iz Eddine El Amrani; Roberto Franchi; Francesco Guerrero; Manuel Martin-Martin; Claudia Patamia; Giuliana Raffaelli; Pedro Robles Marin; Julian Tejera de Leon and Lucilla Tentoni	GIS and new technologies in geological analysis for restoration of islamic monuments of the city of Rabat (Morocco)
14_60	Bahaeddine Alhaddad; Josep Roca Cladera and Malcolm. C. Burns	Remote sensing influence on Urban Agglomeration Delimitation "Spot5 imagery application on the metropolitan area of Barcelona"
14_61	Maria Paola Campolunghi; Giuseppe Capelli and Alessandro Cecili	Roma: Hazard linked to hits holocene alluvial deposits
14_62	Gabriele Cesari; Carlotta Franceschelli; Stefano Marabini; Stefano Mariani; Tiziano Righini; Carlo Berti Ceroni and Marta Marocchi	An experience of safeguard and valorization of the original geological landscape in the osservanza area, Imola (Italy)
14_63	Anna Devyatova; Natalya Ozherelieva	Informational technologies in environmental geochemical research in Novosibirsk city (Siberia)
14_64	Mazza Roberto; Campolunghi Maria Paola and Capelli Giuseppe	A methodology for evaluating cavity related collapse hazard in a North-Eastern sector of Roma (Italy)
14_65	Olga Petrova; Vyacheslav Vlasov; Tatyana Petrova and Petr Miklyaev	Technogenic migration of cesium-137
14_66	Maria Luisa Pulignano; Daniela Ruberti; Maurizio Tescione and Marco Vigliotti	Stratigraphic characteristics of the north eastern margin of Campania plain (southern Italy)
14_67	Roberto Reis	Observations on the geology of the city of Vercelli, Northern Italy
14_68	Josep Roca Cladera; Carlos Marmolejo and Bahaeddine Eddin Alhaddad	Exploring the impact of the urban land use pattern in the spatial formation of residential prices at the metropolitan area of Barcelona
14_69	Daniela Ruberti; Marco Vigliotti; Maria De Falco; Antonella Ermice; Sandro Strumia; Rossana Marzaboli and Maria Petriccione	Research activities and GIS projects for the soil defence: underground monitoring of the Campania plain around Caserta (southern Italy)
14_70	Tarasenko I.A.; Tchepkaia N.A.; Satardinov I.V. and Braçin I.V.	Abandoned mines drainage at a coal mine in Sakhaline island, far east of Russia
14_71	Marit Wennerström; Meri-Liisa Airo; Tuija Elminen and Matti Pajunen	Tectonic evolution as the basis in urban bedrock mapping in the Helsinki area, southern Finland
14_72	Isabel Duarte; António Pinho and Fernando Ladeira	Engineering geological mapping applied to the regional and urban planning of the Agedua Region (Portugal)
14_73	F. La Vigna; T. Ruspandini and R. Mazza	An example of catastrophic subsidence: The doganella sinkhole (Lazio region, Central Italy)
Session 11 DETECTION AND MONITORING GROUND MOVEMENTS UNSING INTERFEROMETRY (DIFSAR) TECHNIQUES		
Day_Poster#	All Authors	Title
14_74	Marek Graniczny; Zbigniew Kowalski; Magdalena Czarnogorska and Andrzej Plotowski	Potential of application of the PSInSAR interferometry for detection of subsidence and active tectonics, Uppers Silesian coal basin study (SW Poland)

POSTER SESSIONS - JUNE 15<sup>th</sup>

Session 2 SOIL CONSERVATION		
Day_Poster#	All Authors	Title
15_02	Jaume Boixadera and Carmen Herrero	The Soil Map (1:25.000) of Catalonia
15_03	N. Calace; A. Di Fabbio; M. Di Legnino; F. Fumanti; I. Rischia and L. Serva	Environmental indicators development for Italian soils (SIAS Project): From regional data to harmonised national information
15_04	Gilbert El Kereh	Textural parametric cartography of loose sediments application of the "Dynamics & environmental index" (DEI)
15_05	Dadvar Lofollahzadeh and Kaveh Khaksar	Rangeland condition, flock movement and soil properties, by using GIS & RS (A Case study from the Namrood catchment, Tehran, IRAN)
15_06	Luis Rodríguez Lado; Florence Carré and Luca Montanarella	Analysis of heavy metal concentrations in soil profiles: necessity of a typology
15_07	I. Simó; J. Costa; J.M. Virgili; C. Herrero and J. Boixadera	Towards a control system for catalonian soils
15_08	Liliana B. Teruggi; Massimo Rinaldi and Lara Coppi	Analysis of channel changes, bank erosion processes and land use modifications in the fluvial corridor along the Cecina river (central Italy)
15_09	Dragana Vidojevic	Soil quality of central Serbia

Session 8 POPULARISATION OF GEOLOGY		
Day_Poster#	All Authors	Title
15_10	Celso Dal Ré Carneiro and Joseli Maria Piranha	Geoscience teaching for environmental education: the case of Sao Jose Do Rio Preto, Sao Paulo State, Brazil
15_11	Albert Martínez; Joan Casólvila and Jordi Cirés	Geologic maps and geologic panels in natural parks: Approaching geology to park visitors
15_12	Albert Martínez; Cai Puigdefàbregas; Jordi Cirés; Ana I. de Paz and Rafael Sevilla	Visualizing geologic maps in 3D: the Ainsa basin geologic map, an educational geoshow3d project
15_13	M. Losantos; X. Berástegui and A. Roca	Popularizing geology: contributions of the servei geològic de Catalunya
15_14	Joseli Maria Piranha; Celso Dal Ré Carneiro and Ronaldo Barbosa	Didactic tools for geosciences teaching based on new information technologies

Session 10 MAPS, INFORMATION SYSTEMS AND NEW TOOLS

Session 10.1 MAPS		
Day_Poster#	All Authors	Title
15_15	Valko Angelov; Stefan Nachev Eli Stefanova and Maria Argirova	First sheets of the geological map of the Republic of Bulgaria in scale 1:50 000
15_16	Massimiliano R. Barchi; Luca G. Bellucci; Giovanni Bortoluzzi; Arnaldo Boscherini; Luca Gasperini; Marco Ligi; Andrea Motti; Cristina Pauselli; Francesco Ponziani and Gianluigi Simone	A geological/geophysical study of the Trasimeno lake in the frame of the Italian Geological-Map project (CARG)
15_17	Bernat Rebolal, M.; Fernández Gianotti, J.; Hernández Manchado, R.; Pérez Cerdán, F.; y Prieto Martín, A.	Interactive geological map of Spain on digital support
15_18	Aldino Bondesan; Alessandro Fontana; Mirco Meneghel; Sandra Primon; Federico Toffoletto; Riccardo Campana; Andrea Vitturi and Valentina Bassan	Mapping late quaternary alluvial plain and coastal area in north eastern Italy: Sheet n.107 "Portogruaro", Geological map of Italy
15_19	Giuseppe Cello, Giovanni Delana and Marcello Principi	Regional cartography as a tool for unravelling Apennine tectonics in central Italy
15_20	Ubaldo Cibin and Marco Stefani	The importance of 3D geological mapping in the stratigraphic interpretation, depositional rate estimation and environmental management of the Po delta region (Ferrara province, northern Italy)
15_21	Carlo Cipolloni; Alessandro Cecili; Maurizio d'Orefice; Francesco dramis and Roberto Graciotti	Geomorphological map of the island of Elba from geo-database application
15_22	Laura Crispini and Giovanni Capponi	The "Genova" quadrangle of the 1/50.000 geological map of Italy, carg project
15_23	de Paz, A. I.; Cirés, J.; Fleta, J.; Rodríguez, J.; Muñoz, A.; Jiménez, J.; Vidal, J. and Lacambra, A.	From geologic databases to geologic offset-printed maps
15_24	Benedetto De Vivo; Annamaria Lima; Maria Anna Bove; Stefano Albanese; Domenico Cicchella; Giuseppe Sabatini; Luigi Antonio Di Lella; Giuseppe Protano; Francesco Riccobono; Pietro Frizzo and Lorenzo Raccagni.	Environmental geochemical atlas of Italy
15_25	Jakup Hoxhaj; Rakip Hysenaj; Vera Gjonj; Piro Leka and Hasan Kuliqi	Quaternary Geological Map of Albania in 1:200000 scale
15_26	Jamičić, D.; Prtoljan, B.; Markulin, Z. and Takač, D.	The correlation between the stress field in the Pannonian and Dinaridic-Adriatic part of Croatia
15_27	Gerhard Mandelsperger and Klaus Poschold	The new 1: 25 000 raw material map of Bavaria
15_28	Vladimir Nevsky	On large-scale mapping of landforms and landscapes
15_29	K. Onuzi; Matarangas D.; M.Pajovic and C.Legler	Correlation of the geological maps 1:50.000 scale of the Albanian - Neighbouring countries border area
15_30	Kujtim Onuzi; Albert Avxhi and Edlira Plaku	Geopotential maps of Albania 1:25.000
15_31	Kujtim Onuzi and L.Gurabardhi	Geological maps 1:50.000 scale of Albania
15_32	Federica Rizzetto; Luigi Tosi and Federico Toffoletto	The new stratigraphic units of the Venice lagoon geological map
15_33	Catherine Satra Le Bris; Claude Augris and Jean-Pierre Mazé	Cartography of the bay of Douarnenez (Brittany, France)
15_34	Peter Scharek	Environmental geological map of Hungary in a scale of 1:100 000
15_35	Ewa Szynkaruk; Gerardo Bocco and Victor Hugo Garduño Monroy	Geomorphologic mapping used for evaluation of active tectonics in the central Trans-Mexican Volcanic Belt
15_36	Arcady V. Tevelev and Boris V. Georgievskiy	Investigation of the eastern ural alpine dynamics using regional geological mapping
15_37	Luigi Tosi; Giuliano Brancolini; Luca Baradello; Federica Donda and Federica Rizzetto	Very high resolution seismic surveys in the lagoon and gulf of Venice shallow waters

Session 10.2 INFORMATION SYSTEMS		
Day_Poster#	All Authors	Title
15_38	Gianni Balestro and Fabrizio Piana	A geological knowledge base model for storing data and sharing interpretations of geological maps
15_39	Mercè Barnolas; M <sup>a</sup> del Carmen Llasat and Laura Bola	Implementation of a flood geodatabase for Catalonia (NE Spain): 1901-2000
15_40	Vincenzo Barrile and Francesco Colroneo	A general purpose GIS Software for exploiting Kosmos, an "OODBMS" server for Geodatabases
15_41	Loredana Battaglini and Silvana D'Angelo	The Carg Project - Geological marine database at the scale 1:25.000. Experimental information system of the geological sheet n°413 "Borgo Grappa-Isola Pontine"
15_42	Battaglini L.; Campo V.; Cipolloni C.; Congi M.P.; Delogu D.; Ventura F.A. and Ventura R.	The data bank interlinked information system of geologic service of Italy-Land management department, Apat (Rome, Italy)
15_43	Carbo, Ester; Pascual, Juan Antonio; Antolin, Carmen and Sánchez, Juan	A GIS approach to determine a regional desertification sensitivity map
15_44	Ilaria Di Cocco and Alberto Marlini	Geology and archaeology: the contribution of the Archeo-Database to the formation of Emilia-Romagna geological cartography (CARG PROJECT)
15_45	Zenonas Gulbinas and Marijus Pileckas	Integrated GIS database for preparation of river basin management and restoration plan: Lithuanian case study
15_46	Lászlo Kuti; József Vatai; Tamás Pocsai and Gábor Karig	The prospects for optimal waste disposal in Hungary
15_47	O. Mimouni; Benhamouche and Baazai	GIS elaboration data base for geotechnical mapping
15_48	Juan Antonio Pascual Aguilar and Juan Sánchez Díaz	The construction of detailed land use-cover maps for the management of the european Natura 2000 network sites in the Valencia region, Spain
15_49	Maurizio Pignone	The Geographical Information System of Cesis Project
15_50	Daniela Ruberti; Marco Vigliotti; Maria De Falco; Sandro Strumia; Maurizio Muselli; Monica Sebillio; Annalisa Santangelo and Vincenzo Del Fatto	The use of GIS for environmental data management in the department of environmental sciences (Second University of Naples, Italy)
15_51	Victor Spiridonov	New technology of compilation of geological maps based on object-oriented vectorization and generalization

Session 10.3 NEW TOOLS		
Day_Poster#	All Authors	Title
15_52	Janusz Badura; Bogusław Przybylski; Krzysztof Urbański and Witold Zuchewicz	Digital elevation models to geological and geomorphological studies - some examples of SW Poland
15_53	Núria Carrera; Josep Anton Muñoz and Eduard Roca	New methodology to 3D reconstruction of folds: application to the Cerro Bayo anticline (Cordillera Oriental, N Argentinean Andes)
15_54	Esmeralda Caus; Carme Boix; Josep M. Bernaus and Raquel Villalonga	Are fossils useful for solving cartographical problems? A case history: the upper cretaceous of the south pyrenean margin
15_55	Jacek Chelminski; Maciej Rossa and Maciej Tomaszczyk	The 3D modelling of geological structures of Poland - review of Polish Geological Institute projects
15_56	Dessimoz M.; Cheseaux G.; Ravot E.; Jaboyedoff M.; Schreiber L.; Sartori M.; Jemelin L.; Osterling N.; Kuehni A.	Processes, tools and methods for the vectorization of Swiss geological maps
15_57	Fleta, J.; Serra, C.; Van Eeckhout, J.A.; Leopart, A.; Pujal, E.; Roca, A.; Palma, E.	Document Management System (DMS) for the technical reports of the Geologic Institute of Catalonia/Cartographic Institute of Catalonia
15_58	David García-Sellés; Pau Arbués; Oriol Falivene; Josep Anton Muñoz and Jaume Calvet	A workflow for the geological study of 3D outcrops acquired with lidar
15_59	Ibáñez, Joan Josep and Burriel, José Angel	MCSC: a high-resolution thematic digital cartography
15_60	Maria J. Iniesto Alba; Pablo Carballo Cruz and Manuel Segura Redondo	Map viewer for the analysis of the first series of the spanish geological map at a scale of 1/50.000
15_61	Michel Jaboyedoff; Marc-Henri Derron; Richard Metzger and Dominique Turmel	New insight techniques to represent and to analyze relief using DEM: COLTOP-3D software
15_62	Asunción Julián Andrés and Javier Chueca Cia	Mapping horizontal and vertical movement in Besiberris rock glacier (central Pyrenees, Spain) using geostatistical kriging interpolation methods
15_63	Joana Mencos; Josep Anton Muñoz and Stuart Hardy	3D Geometry and Numerical Modelling of the Sant Corneli anticline (southern Pyrenees)
15_64	O.V. Petrov; L.A. Daragan-Sushchova and N.N. Sobolev	Tectonic map of north West Siberian oil-and-gas province
15_65	Xavier Pons; Joan Masó and Lluís Pesquer	A vector based methodology for the interpolation of dtm from vector data
15_66	Alberto Riva and Marco Stefani	GPS-assisted mobile-GIS geological mapping as a tool for reconstructing middle triassic platform growth and carbonate production (Dolomites, northern Italy)
15_67	Francesca Salvi; Simone Sironi; Simone Sterlacchini and Andrea Zanchi	A methodological approach for 3D reconstructions of subsurface geological units: from Italian "carg" database to 3D modeling
15_68	Miquel Vilà	Extraction of reliable geologic planes from georeferenced data using the ordinary squares method

Session 12 GEOTURISM AND HERITAGE		
Day_Poster#	All Authors	Title
15_69	Andreas Börner; Karsten Schütze; Andrzej Piotrowski; Ryszard Dobracki and Malgorzata Schiewe	Geotourist map of the Pomerania region
15_70	Cerrina Feroni Andrea; Elero Alessandro and Oltrria Giuseppe	Possible touristic exploitation of geological outcrops: the case of Rocca Grimalda (Piedmont Region, Italy)
15_71	Roberto Franchi; Francesca Colosi; Pierre Drap; Roberto Gabrielli; Alessandra Lazzari and Daniela Peloso	New technologies and GIS for the knowledge and the restoration of a monumental site: the ancient water supply system of Petra
15_72	Marco Giardino; Walter Alberto; Daniele Giordan; Maura Giuliano and Pierluigi Pellegrino	GIS and geochemic mapping for tourism enhancement and geodiversity protection: examples from the western Alps
15_73	Nadia Herrero and Salvador Grau	Inventory of sites of geological interest in Catalonia
15_74	Stefano Mariani and Stefano Marabini	Natural hydrocarbons emissions in Emilia Romagna: history, education potential and the present value of Attilio Scicli's work (1892-1975)
15_75	Amparo Nuñez; Felipe Bull; Andrés de Mesa and Joaquin Regot	Survey of a greek temple in the archaeological park of Selinunte, Trapani Sicilia (Italy)
15_76	Lajos Seke and Tatjana Sijacki	Fruska gora-potential Geopark
15_77	Marco Stefani and Emanuele Borasio	Fluvial sedimentation and the development of Roman Empire necropoleis in the Po delta area (Ferrara province, northern Italy): A regional environmental perspective

**POSTER SESSIONS - JUNE 16th**

Session 5 GEOLOGICAL RISK ASSESMENT AND SECURITY POLICIES		
Day_Poster#	All_authors	Title
16_02	Massimiliano Bencardino	A Spatial Decision Support System for the Strategic Environmental Assessment of the General Town Planning of Casalbore District (Av)
16_03	Anna Maria Blumetti; Pio Di Manna, Luca Ferrelli; Domenico Fiorenza; Roberto Serafini; Eutizio Vittori; Fabrizio Vasile; Fabio Badalamenti and Antonino Brancato	Vulnerability of water supply network by capable faults in the etna region (vulnera- FCE project)
16_04	Bastien Colas; Jordi Cirés; Sara Figueras; Agathe Roullé; Albert Macau and Jorge Fleta	Geological and lithological characterization for a seismic zonation in a border region (Cerdanya, Spain-France)
16_05	Maria Guinau and Joan Manel Vilaplana	Debris flow spatial prediction considering source and runout zones: examples from NW Nicaragua after hurricane Mitch
16_06	Maria De Falco, Domenico De Lucia; Assunta Esposito; Elisabetta Fava; Patrizia Iovine; Carolina Paoella; Maria Petriccione; Daniela Ruberti and Marco Vigliotti	Emergency plan of civil defend about natural and anthropic risks
16_07	Pio Di Manna; Anna Maria Blumetti; Domenico Fiorenza; Luca Ferrelli; Francesca Giardina; Alessandro Michetti; Leonello Serva and Eutizio Vittori	ITHACA (Version 2006): New data on capable faults in Italy
16_08	Carles Fernández-Lavado and Glòria Furdada	Flood hazard mapping in Jucuarán Municipality (El Salvador, CA)
16_09	Fleta, J.; Godé, Ll.; Goma, Ll.; Gracia, A.; Gracia, J.; Martínez, J.; Marturià, J.; Palma, J.J.; Pardo, M.; de Paz, A.; Sánchez, I.; Verdaguer, I.	Flooding areas and risk analysis of Catalonia (Inunecat plan)
16_10	Jorge P. Galve; Francisco Gutiérrez; Juan Remondo; Jaime Bonachea; Jesús Guerrero; Pedro Lucha; Mateo Gutierrez and José A. Sánchez	Is it possible to predict the spatial distribution of sinkholes? The case study of the Ebro Valley alluvial evaporite karst (NE Spain)
16_11	Erwin Geiss and Joachim Wassermann	A new seismotectonic map of Bavaria-Status Report
16_12	Fortunato Giordano and Saverio Fiore	An information system for monitoring asbestos' risk in Basilicata (Italy)
16_13	Vojin Gordanic; Aleksandra Ciric; Dragan Jovanovic and Zora Zunic	Geocological maps as basis for definition of zero-level of natural radioactivity in the part of Bujanovac granitoide massif (southern Serbia)
16_14	Barbara Justin; Igor Veber and Zoran Pavšek	The Program of the Landslide Risk Assessment in the Lukovica Commune
16_15	Olga Larikova and Olga Mitrakova	Analysis of natural conditions, technogenic risks and resources for identification of optimal development strategy of a region
16_16	G.R. Lashkaripour and M. Ghafoori	Groundwater decline and Land subsidence in Mashhad plain, northeast Iran
16_17	Margarita Matova	Study of the seismo-hydrogeological vulnerability for security policy in Balkan region
16_18	Bakhtiar Nurtaev	Landslide hazard assessment in mountainous areas of Uzbekistan using GIS
16_19	Pedroso Herrera Ida Ines; Manuel J. Fundora Granda; Bertha Elena González Raynal; Ismael Gonzalez Metauten and Mario Guerra Oliva	Geologic and geophisic risks assessment for the coastal municipality of playa in western Habana, Cuba. A GIS application
16_20	Andrzej Piotrowski and Małgorzata Schiewe	Shallow seismic geophysical investigations in Gorzów Wlkp. Upland - Noth-West part of Poland
16_21	Francesco Ponziani; Marco Ogna; Arnaldo Boscherini; Andrea Motti; Alessandro Severi and Maurizio Tesorini	Studies of the local seismic hazard in areas with important buildings: Application of a new local law aimed at reducing the seismic risk
16_22	Shukhrat Radjabov and Nasirdjan Takhirov	Studying of the seismic-ecological problems in areas techno-genetic objects on the Turanian platform: ecological danger and management
16_23	Simone Sterlacchini; Mario Canziani; Simone Frigerio; Mattia De Amicis; Simone Sironi; Simone Poli and Angelo Cavallin	Civil protection plan: a new GIS tools for emergency information management
16_24	Kh.A.Akbarov; A.N. SultanKhodjaev; G. Yu. Azizov and Sh. S. Yusupov	Strategy of earthquakes prediction in Uzbekistan
Session 9 REMOTE SENSING APPLICATIONS		
Day_Poster#	All_authors	Title
16_25	J.K.Jena; P.K.Verma and H.K.Sahoo	Development of groundwater exploration GIS in parts of Sambalpur district, Orissa, India
16_26	Rafael Pereira Zanardi; Silvia Beatriz and Alves Rolim	Quality control of DTM extracted from cbers-2 images
16_27	Luigi Perotti; Enrico Borgogno Mondino; Marco Giardino and Stefano Russo	Orthoprojection of MIVIS airborne hyperspectral images: Methodology and applications in the Aosta valley (Italy)
16_28	Lidia Quental and João Matos	Land cover mapping using QuickbirdTM Imaginery: Preliminary results of the mining area of Aljustrel, Iberian Pyrite Belt
16_29	Josep Roca Cladera; Laura Camprubi Trepal and Bahaa Eddin Alhaddad	Assessing the relationship between the compactness of the urban form and the existence of holidays home in the Catalan landscape
16_30	Josep Roca Cladera; Anna Garcia Masiá and Bahaa Eddin Alhaddad	Improve residential classification density by physical GIS entities
16_31	Irina Sidorova	Complex study of anomalous geobjects of the Lithosphere using GIS&RS (Western Uzbekistan)
16_32	Sandra Silva; Ricardo Caranova; João Cabral and Ana Maria Costa	Analysis and interpretation of Landsat TM 5 satellite images from North Portugal

NOTES

---



NOTES

---